

NO. 19 SPREADER

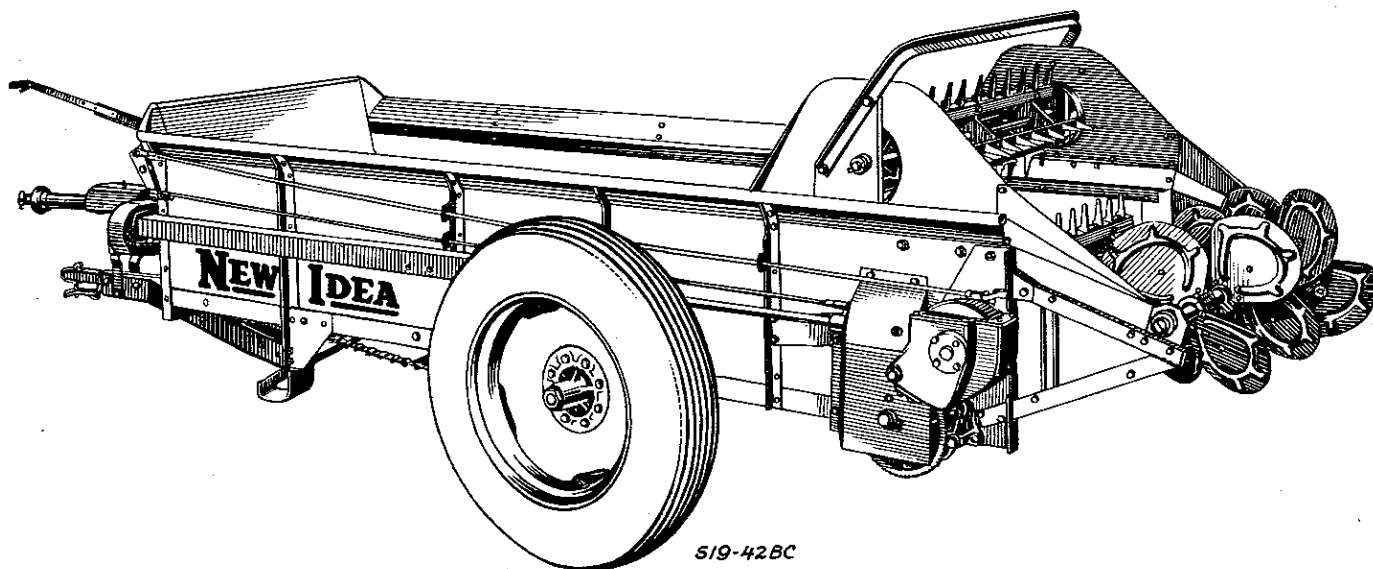

Year Built 1956 to 1960

Lots 377 to 416

INDEX OF NO. 19 SPREADER

Axle and Wheels	54
Bottom	51
Distributor	57-58
Endgate Attachment	68
Endgate and Lever	52
Feed Shaft and Conveyor	61-62-63-64
Gear case	59-60
Hitch	53
Main cylinder	55
Main drive shaft	64-65
P.T.O. Drive bearing and brackets	66
P.T.O. Shielded Drive	69
P.T.O. Telescope Drive	67
Sides and arch	50-51
Special Outboard Feed Shaft Bearing	70
Telescoping Shaft and Clutch Disc	69
Upper cylinder	56-57
Forage Box Sides	70-71

SIDES AND ARCH NO. 19 SPREADER

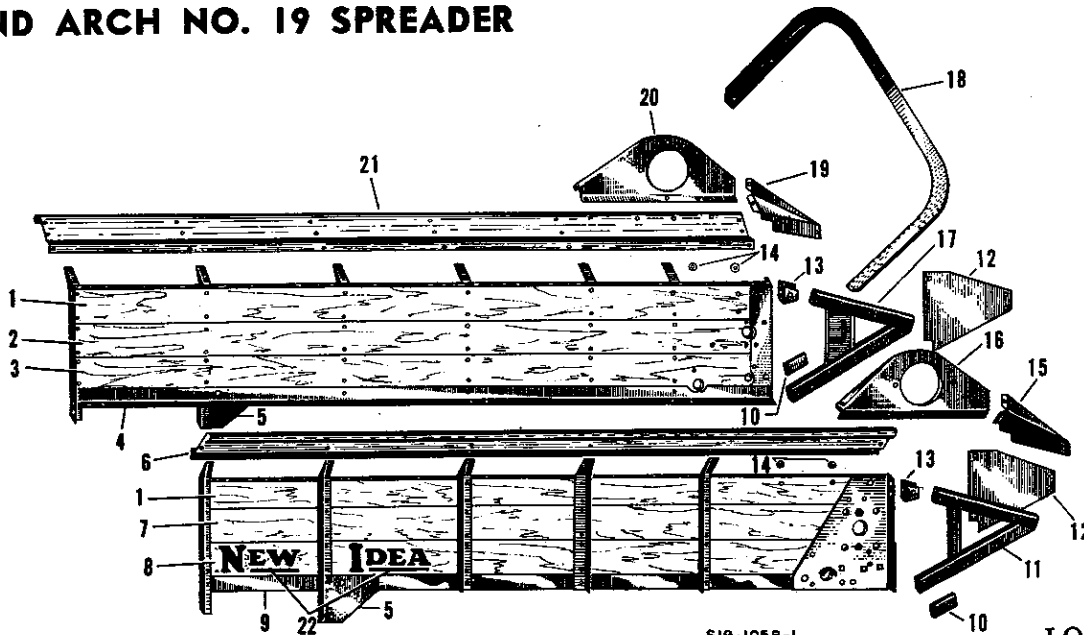

NO. 19 SPREADER

S19-1058-1

LOT 377 to 416

Ref.	Part No.	Description	Lot No.	Wt.Lbs.
1	W 6 SR	Top board, right & left side (2 used)..... Rivet, truss hd., 3/8 x 1-3/8" (2 used) Rivet, truss hd., 5/16 x 1-3/16" (6 used)	377 to 416	20
2	W 7 SR	Center, board, right side Rivet, truss hd., 5/16 x 1-3/16" (10 used) Rivet, truss hd., 3/8 x 1-3/8" (2 used)	377 to 416	12
3	W 8 SR	Bottom board, right side Rivet, truss hd., 5/16 x 1-3/16" (10 used) Rivet, truss hd., 3/8 x 1-3/8" (2 used)	377 to 416	14
4	W 54 SRA	Side complete, right, Order W 54 SRA-1).....	377 to 408	100
	W 54 SRA-1	Side complete, right.....	411 to 416	100
5	0696 SR	Gusset plate, 3/16" thick..... Rivet, button head, 1/2 x 1-1/4"	377 to 416	3
6	0681 SR	Steel flare (left) 143-3/8" long, Order 0681 SR-1.....	377 to 408	49
	0681 SR-1	Steel flare (left) 143-3/8" long..... Machine screw, 5/16 x 3/4" (10 used) Machine screw, 5/16 x 1-1/2" (6 used)	411 to 416	49
7	W 45 SR	Center side board, left..... Rivet, truss hd., 5/16 x 1-3/16" (10 used) Rivet, truss hd., 3/8 x 1-3/8" (2 used)	377 to 416	14
8	W 46 SR	Bottom side board, left Rivet, truss hd., 5/16 x 1-3/16" (10 used) Rivet, truss hd., 3/8 x 1-3/8" (2 used)	377 to 416	14
9	W 53 SRA	Side complete, left, Order W 53 SRA-1).....	377 to 408	100
	W 53 SRA-1	Side complete, left.....	411 to 416	100
10	0320 SR	Reinforcement plate for distributor, 1/8 x 2" flat, 3-1/2" long (2 used)	377 to 406	1/2
11	0741 SRA	Distributor support assembly, left..... Bolt, carriage, 3/8 x 1-3/4" (2 used) Bolt, machine, 1/2 x 2"	377 to 416	10-1/2
12	0294 SR	Filler sheet for distributor, 13 x 14-1/2" long, 20 Ga. (2 used)..... Bolt, machine, 5/16 x 1-1/2" (2 used)	377 to 416	1-1/2
13	0148 SR	Distributor fastener bracket, 3/16 x 3" flat, 6-1/2" long (2 used).... Bolt, machine, 3/8 x 1" (2 used)	377 to 416	1
14	K 2880	Washer, 1" O.D., 7/16" I.D., 1/16" thick (4 used)	377 to 416	1 oz.
15	0745 SR	Distributor support shield left, Order 0745 SR-1	377 to 408	1-3/4
	0745 SR-1	Distributor support shield left..... Machine screw, 5/16 x 3/4" (2 used) Bolt, machine, 5/16 x 1-1/2" (2 used)	411 to 416	1-3/4
16	0764 SR	Upper cylinder shield, left, Order 01426 SRA	377 to 408	7-1/4
	01426 SRA	Upper cylinder shield, left..... Machine screw, 5/16 x 3/4" (4 used)	411 to 416	7-1/4

SIDES AND ARCH NO. 19 SPREADER (CON'T)

Ref.	Part No.	Description	Lot No.	Wt.Lbs.
17	0742 SRA	Distributor support assembly, right..... Bolt, carriage, 3/8 x 1-3/4" (2 used)	377 to 416	10-1/2
18	0739 SR 200343	Arch angle, 3/16 x 1-1/2" x 1-1/2" angle, 87" long (Order 200343).. Arch angle	377 to 416	10-3/4
19	0744 SR	Distributor support shield, right, Order 0744 SR-1.....	377 to 408	1-3/4
	0744 SR-1	Distributor support shield, right..... Machine screw, 5/16 x 3/4" (2 used) Bolt machine, 5/16 x 1-1/2" (2 used)	411 to 416	1-3/4
20	0765 SR	Upper cylinder shield, right, Order 01425 SR	377 to 408	7-1/4
	01425 SR	Upper cylinder shield, right..... Machine screw, 5/16 x 3/4" (4 used)	411 to 416	7-1/4
21	0682 SR	Steel flare, right, 143-3/8" long, Order 0682 SR-1.....	377 to 408	49
	0682 SR-1	Steel flare, right, 143-3/8" long..... Machine screw, 5/16 x 3/4" (10 used) Machine screw, 5/16 x 1-1/2" (6 used)	411 to 416	49
22	K 1923	New Idea 5" stencil.....	377 to 416	1 oz.

BOTTOM

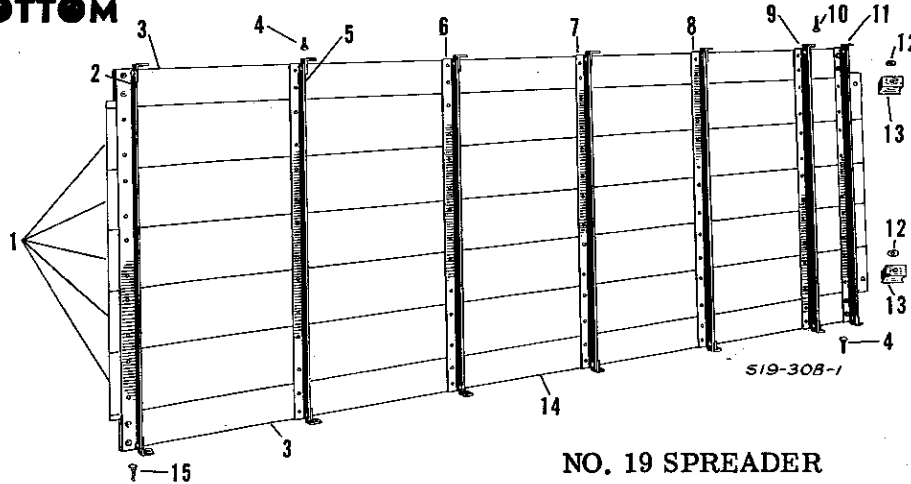

NO. 19 SPREADER

LOT 377 to 416

Ref.	Part No.	Description	Lot No.	Wt.Lbs.
1	W 9 SR	Center board (5 used)	377 to 416	13
		Rivet, truss head, 1/4 x 1-3/16" (14 used)		
2	0664 SRA	Front bottom cross angle assembly, 5/32 x 1-1/2 x 2 x 44-5/32" long	377 to 416	7
		Rivet, truss hd., 1/4 x 1-3/16" (14 used)		
3	W 43 SR	Outside board (2 used)	377 to 416	7
		Rivet, truss head, 1/4 x 1-3/16" (14 used)		
4	K 2941	Bolt, carriage, 1/2 x 1-1/4" special (4 used)	377 to 416	1 oz.
5	0665 SRA	Second Bottom cross angle assembly, 5/32 x 1-1/2 x 2 x 44-11/32" long	377 to 416	7
		Rivet, truss head, 1/4 x 1-3/16" (14 used)		
6	0666 SRA	Third bottom cross angle assembly, 5/32 x 1-1/2 x 2 x 44-17/32" long	377 to 416	7
		Rivet, truss head, 1/4 x 1-3/16" (14 used)		
7	0667 SRA	Fourth bottom cross angle assembly, 5/32 x 1-1/2 x 2 x 44-23/32" long	377 to 416	7
		Rivet, truss head, 1/4 x 1-3/16" (14 used)		
8	0668 SRA	Fifth bottom cross angle assembly, 5/32 x 1-1/2 x 2 x 44-29/32" long	377 to 416	7
		Rivet, truss head, 1/4 x 1-3/16" (14 used)		
9	0669 SRA	Sixth bottom cross angle assembly, 5/32 x 1-1/2 x 2 x 45-3/32" long	377 to 416	7
		Rivet, truss head, 1/4 x 1-3/16" (14 used)		
10	K 3197	Bolt, carriage, 1/2 x 1-1/2" special	377 to 416	1 oz.
11	0670 SRA	Rear bottom cross angle assembly, 5/32 x 1-1/2" x 2 x 45-5/32" long	377 to 416	7
		Rivet, truss head, 1/4 x 1-3/16" (14 used)		

BOTTOM (CON'T)

Ref.	Part No.	Description	Lot No.	Wt. Lbs.
12	K 814	Washer, 1" O.D., 7/16" I.D., 1/16" thick (2 used) Order K 2880	377 to 386	1 oz.
	K 2880	Washer, 1" O.D., 7/16" I.D., 1/16" thick electro galvanized	390 to 416	1 oz.
13	W 44 SR	Feed shaft support, 1-1/2 x 2-1/2 x 3-7/8" (2 used)	377 to 416	1/2
		Bolt, carriage, 3/8 x 3"		
14	W 43 SRA	Bottom assembly, complete (Order W 119 SRA)	377 to 416	139
	W 119 SRA	Bottom assembly complete		
15	K 2940	Bolt, carriage, 1/2 x 1-1/8" special (9 used)	377 to 416	1 oz.

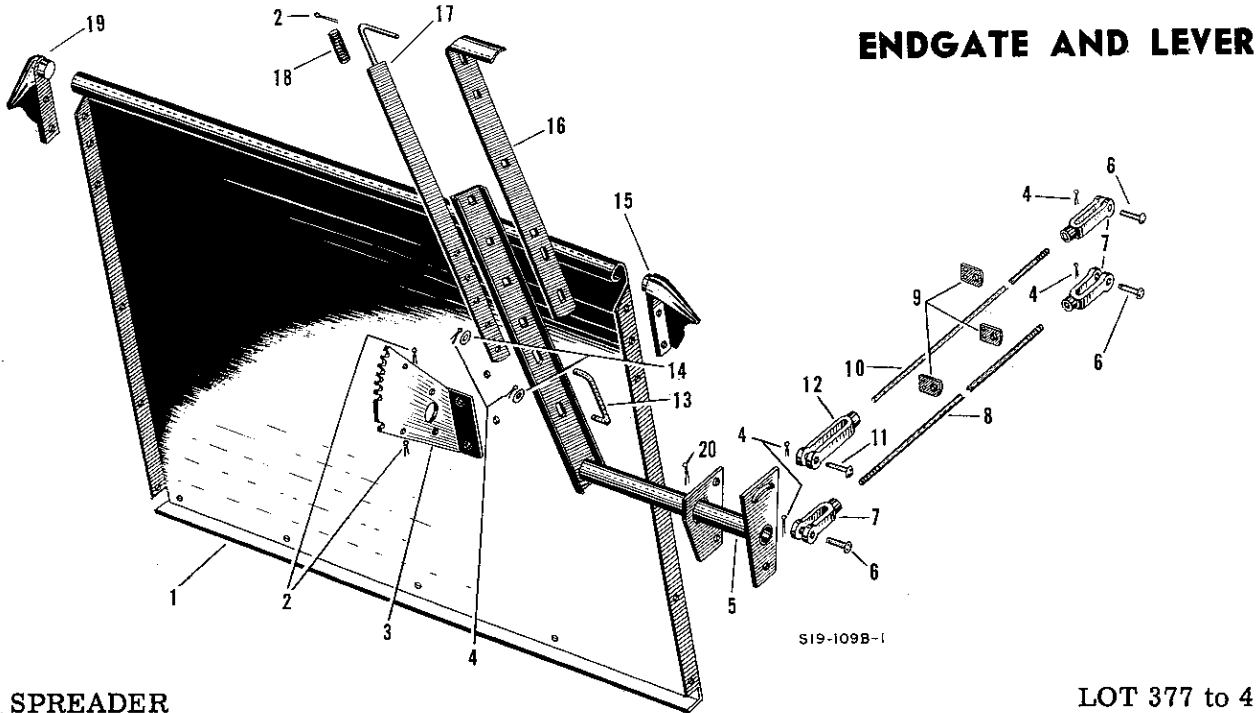

NO. 19 SPREADER

LOT 377 to 416

Ref.	Part No.	Description	Lot No.	Wt. Lbs.
1	0738 SR	Front endgate	377 to 416	36-1/4
		Bolt, machine, 3/8 x 3/4" (5 used)		
2	K 1090	Cotter pin, 1/4 x 3/4" with 11/32" diameter hole in eye (3 used) ...	377 to 416	1 oz.
3	0809 SR	Lever sector, 3/16" thick	377 to 400	4
	01158 SR	Lever Sector	403 to 416	
		Bolt, machine, 3/8 x 3/4" (2 used)		
4	K 1071	Cotter pin, 1/8 x 3/4" (6 used)	377 to 416	1 oz.
5	0701 SRA	Feed control assembly	377 to 416	11
		Bolt, machine, 3/8 x 1-3/4" (2 used)		
6	K 2540	Rivet for short yokes, 3/8 x 1-1/4" drilled (3 used)	377 to 416	2 oz.
7	84 SR	Yoke for control rod (short) (3 used)	377 to 416	1/2
8	0715 SR	Feed adjusting rod, 7/16" dia., 119" long	377 to 416	8
9	0776 SR	Feed rod guide (3 used)	377 to 416	3/4
		Bolt, machine, 1/4 x 3/4" (6 used)		
10	0714 SR	Clutch control rod, 7/16" dia., 130-1/2" long	377 to 416	9
11	2661 P	Rivet for long yoke, 3/8 x 1-1/2" button hd. (drilled)	377 to 416	2 oz.
12	85 SR	Yoke for clutch rod (long)	377 to 416	3/4
13	1735 S	Sector lock rod, 3/8 Rd. 10-3/8" long drilled	377 to 416	4
14	K 814	Washer, 1" O.D., 7/16" I.D. 1/16" thick (2 used) Order K 2880	377 to 386	1 oz.
	K 2880	Washer, 1" O.D., 7/16" I.D., 1/16" thick electro galvanized	390 to 416	1 oz.
15	88 SR	Front endgate corner (left) (Order 200047)	377 to 416	3
	200047	Front endgate corner, left		
16	1629 S	Feed lever 1/4 x 1-1/2" flat, 27-1/8" long	377 to 416	2-1/2
		Bolt, carriage, 3/8 x 7/8" (2 used)		
17	1033 SA	Main lever rod with handle, 1/8 x 7/8" flat 30-1/8" long	377 to 416	1'
18	1509 S	Spring, compression, 5/8 O.D., 2-1/2" long, 13 coils	377 to 416	3 oz.
19	87 SR	Front endgate corner right (Order 200046)	377 to 416	3
	200046	Front endgate corner right		
20	K 1084	Cotter pin, 3/16 x 1-3/4"	377 to 416	1 oz.

HITCH ASSEMBLY

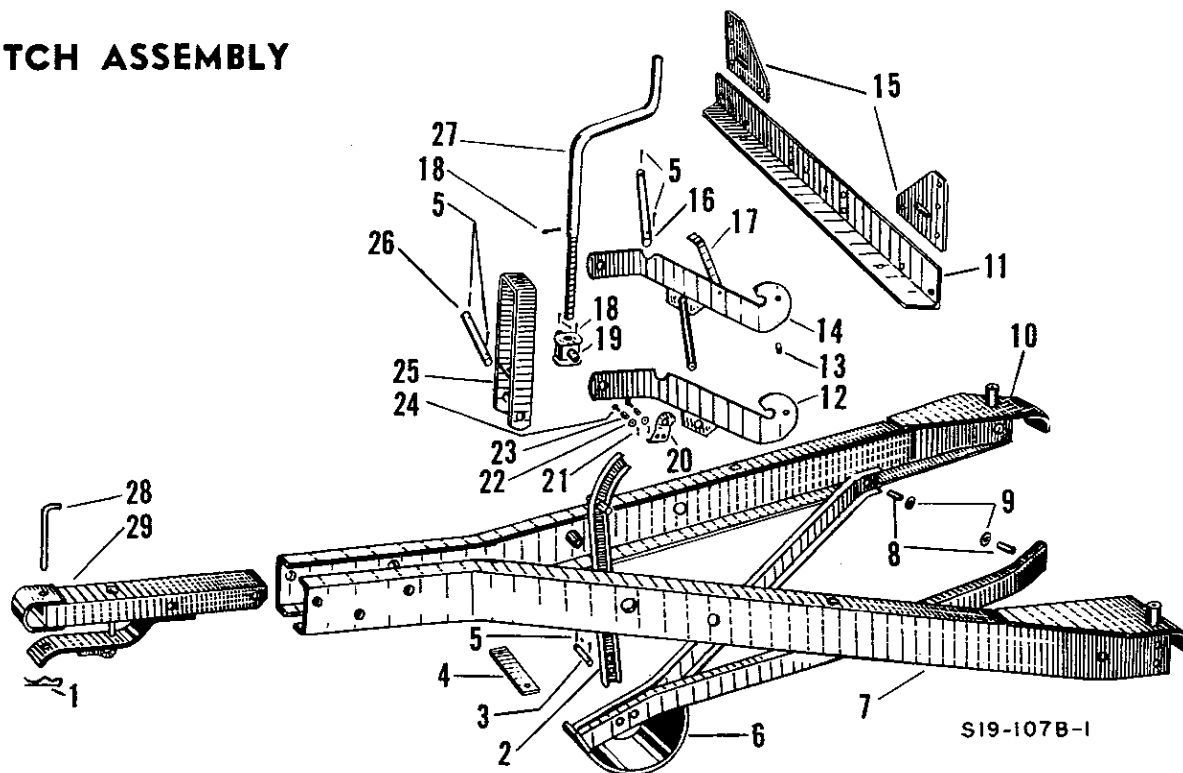

NO. 19 SPREADER

LOT 377 to 416

Ref.	Part No.	Description	Lot No.	Wt.Lbs.
1	2629 P	Hitch pin clip.....	377 to 416	1 oz.
2	1004 SA	Sliding arm, 1-1/2 x 21/32", I bar, 21-1/4" long.....	377 to 416	2-1/2
3	1006 S	Pin in shoe assembly, 3/4" rd., 2-1/2" long.....	377 to 416	1/4
4	0748 SR	Tie strap for hitch, 1/4 x 1-1/4 x 5-3/8" long.....	377 to 416	2
		Bolt, machine, 1/2 x 1" (2 used)		
5	K 1082	Cotter pin, 3/16 x 1-1/4" (6 used).....	377 to 416	1 oz.
6	0730 SRA	Shoe brace assembly.....	377 to 416	14
		Bolt, machine, 1/2 x 1-1/2" (2 used)		
7	0747 SRA	Hitch channel assembly, left.....	377 to 416	39-1/4
		Bolt, machine, 1/2 x 1-1/4" (2 used)		
8	1009 S	Bushing, 3/4" O.D., 5/8" long (2 used).....	377 to 416	2 oz.
9	K 837	Washer, 1-3/8" O.D., 9/16" I.D., 1/16" thick (2 used), Order K-2881.....	377 to 386	1 oz.
		Washer, 1-3/8" O.D., 9/16" I.D., 1/16" thick electro galvanized....	390 to 416	1 oz.
10	0746 SRA	Hitch channel assembly, right.....	377 to 416	40-1/4
11	0749 SR	Cross angle on hitch, 3 x 2 x 3/16" angle, 44-15/16" long.....	377 to 416	12
		Bolt, machine, 3/8 x 1" (2 used)		
		Bolt, machine, 5/8 x 1-1/4" (2 used)		
		Bolt, machine, 5/8 x 1-1/2" (2 used)		
12	0392 SRA	Left adjusting arm complete, (Order 200234).....	377 to 411	4
	0392 SRA-1	Left adjusting arm, complete (Order 200234).....	416 only	
	200234	Left adjusting arm, complete.....		
13	1001 S	Spacer, 3/8" I.D., 7/8" long.....	377 to 416	1 oz.
14	0393 SRA	Right adjusting arm, complete, Order 0393 SRA-1.....	377 to 411	4
	0393 SRA-1	Right adjusting arm, complete.....	416 only	
15	0500 SR 1	Front end reinforcement plate (2 used).....	377 to 416	2
		Bolt, machine, 1/2 x 1" (4 used)		
16	0729 SR	Pivot rod, 7/8" rd., 17-3/8" long, drilled.....	377 to 416	3
17	999 S	Lock for adjusting arm, 3/16 x 1" flat, 10-1/2" long.....	377 to 416	3/4
18	K 1094	Cotter pin, 1/4 x 1-1/2" (3 used).....	377 to 416	1 oz.
19	L 487	Pivot nut for adjusting crank.....	377 to 416	1
20	1305 S	Latch for sliding arm.....	377 to 416	1/4
21	K 1066	Cotter pin, 3/32 x 1/2" (2 used).....	377 to 416	1 oz.

HITCH ASSEMBLY (CON'T)

Ref.	Part No.	Description	Lot No.	Wt.Lbs.
22	K 807	Washer, 3/4" O.D., 5/16" I.D., 3/64" thick (2 used), Order K-2878	377 to 386	1 oz.
	K 2878	Washer, 3/4" O.D., 5/16" I.D., 3/64" thick, electro galvanized.....	390 to 416	
23	1307 S	Spring, compression, 1/2" O.D., 15/16" long, 5 coils (2 used)	377 to 416	1 oz.
24	1306 S	Pin for sliding arm latch, 1/4" dia., 1-1/4" long (2 used)	377 to 416	1 oz.
25	995 SA	Guide for adjusting crank, 5/16 x 2" flat, 26-1/4" long.....	377 to 416	5-1/4
26	0396 SR	Pin for adjusting guide, 7/8" rd., 4-15/16" long.....	377 to 416	3/4
27	0391 SR	Lift crank, 7/8" rd., 27-1/2" long	377 to 416	3-1/2
28	550 P1	Hitch pin, 3/4" dia., 7-1/4" long	377 to 416	1
29	0727 SRA	Hitch tube assembly.....	377 to 416	16-1/2
		Bolt, machine, 5/8 x 4-1/4" (2 used)		

AXLE AND WHEELS

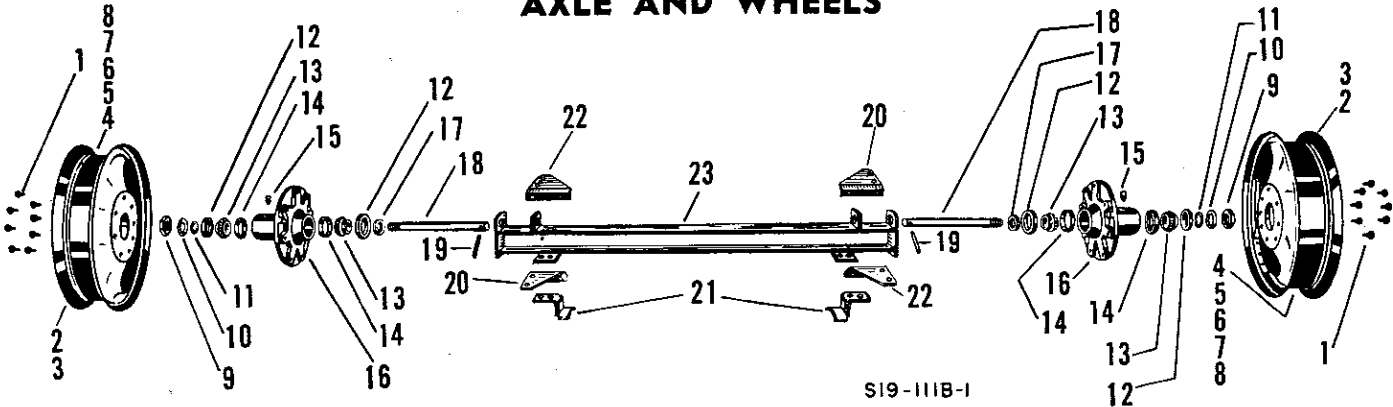

NO. 19 SPREADER

LOT 377 to 416

Ref.	Part No.	Description	Lot No.	Wt.Lbs.
1	1078 S	Hub bolt for disc wheel, 9/16" Dia., 1-1/4" long (16 used)	377 to 416	1/4
2	K 2599	Flange ring for semi drop center disc wheel for K 2598 rim	377 only	4-3/4
3	K 1214	Flange ring for semi drop center disc wheel for K 1213 rim	377 only	4-3/4
4	K 3374	Disc wheel and rim assembly 20"	386 to 416	34-1/2
5	K 2598	Semi drop center disc wheel with flange ring, 20" Order K 3374 ...	377 only	34-1/2
6	K 1213	Semi drop center disc wheel with flange ring, 20"	377 only	60
7	K 1821	Disc wheel, 24" (2 used). Order K3174	377 to 390	61
8	K 3174	Disc wheel assy. 24" x 7"	396 to 416	45-1/2
9	2634 P	Take up nut for stub axle, 2-3/16" dia., 1/2" thick (2 used)	377 to 416	1/4
10	2635 P	Washer for locking nut on axle, 2-9/16" O.D., 1-33/64" I.D., 5/64" thick (2 used)	377 to 416	2 oz.
11	K 1783	Washer for wheel hub, 2" O.D., 1-17/32" I.D., 5/64" thick	377 to 416	2 oz.
12	K 1662	Felt closure, Timken No. 65300 (4 used)	377 to 416	3 oz.
13	K 1665	Bearing cone, 1-1/2" bore, Timken No. 13686 (4 used)	377 to 416	1/4
14	2646 PC	Roller bearing cup, Timken No. 13621 (2 used)	377 to 416	1/2
15	K 1690	Grease fitting, 1/8" pipe thread, 67-1/2 degree elbow (2 used)	377 to 416	1 oz.
16	E 386 A	Hub for rubber tire disc wheel with cups (2 used)	377 to 416	24-1/2
17	0205 SR K 4626	Spacer for inner bearing, 2-1/4 O.D., 1-1/2 I.D., 1/4" thick (Order K4626) Spacer for inner bearing	377 to 416	1/4
18	0132 SR	Stub axle for ground wheel, 1-1/2" Rd., 13-3/4" long drilled (2 used) order 0132 SR 1	377 only	6-3/4
	0132 SR-1	Stub axle for ground wheel, 1-1/2" rd., 13-3/4" long drilled (2 used)	386 to 416	6-3/4
19	K 1909	Groove pin, 7/16 x 2" long (2 used)	377 to 416	2 oz.
20	0676 SR	Bracket for axle support, 1/4" flat, right rear and left front	377 to 416	1-3/4
		Bolt, machine, 1/2 x 1-1/2" (2 used)		
		Bolt, machine, 1/2 x 1-1/4" (4 used)		
21	0181 SRA	Conveyor slide assembly (2 used)	377 to 416	1-1/2
		Bolt, machine, 3/8 x 1" (4 used)		
22	0675 SR	Bracket for axle support, 1/4" flat, right front and left rear	377 to 416	1-3/4
		Bolt, machine, 1/2 x 1-1/2" (2 used)		
		Bolt, machine, 1/2 x 1-1/4" (4 used)		
23	0409 SRA-1	Main axle assembly. Order 0409 SRA-2	377 only	42
	0409 SRA-2	Main axle assembly	386 to 416	42

MAIN CYLINDER

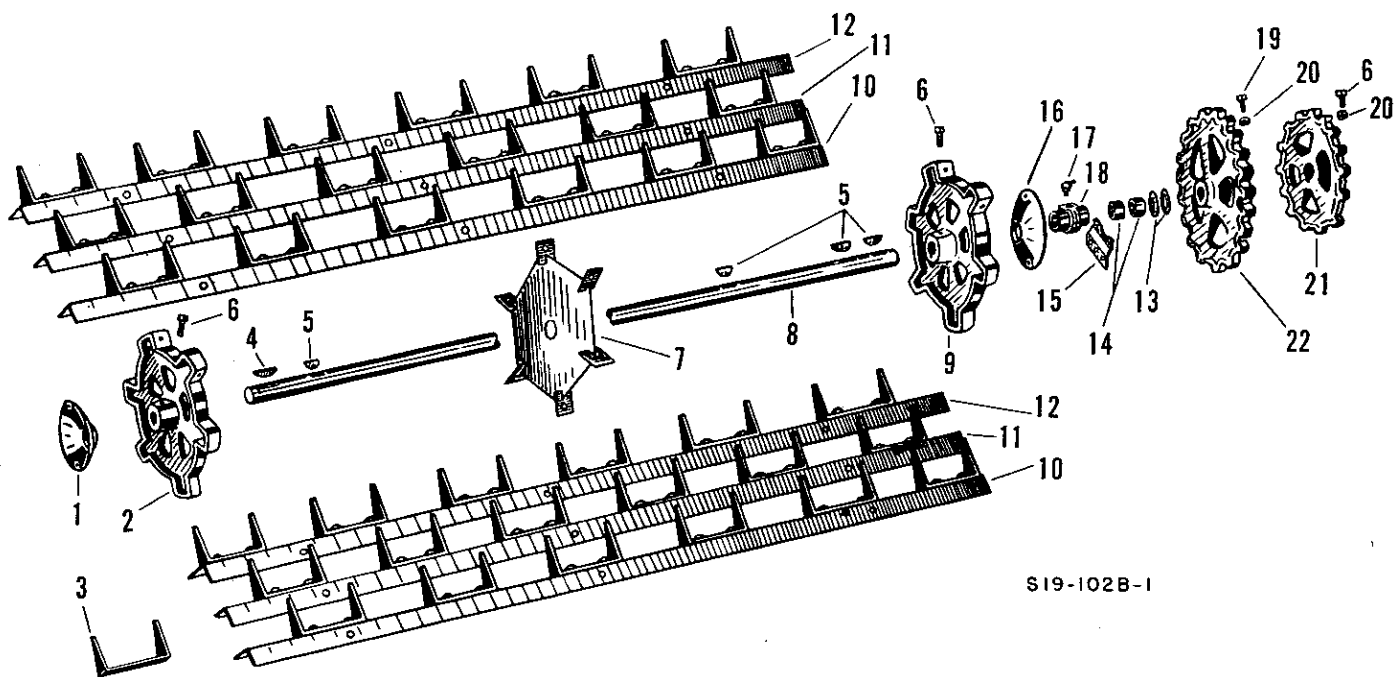

S19-102B-1

NO. 19 SPREADER

LOT 377 to 416

Ref.	Part No.	Description	Lot No.	Wt. Lbs.
1	0697 SR	Anti-wrap shield for cylinder (Left)	377 to 416	3/4
		Bolt, machine, 5/16 x 1-1/2" (2 used)		
2	58 SR	Main cylinder head left, 1-1/4" bore	377 to 416	11-1/2
3	0312 SR	Cylinder tooth, 1/4 x 1-1/4" flat, 10-1/16" long (36 used)	377 to 416	3/4
		Rivet, button head, 5/16 x 7/8" (2 used)		
4	K 587	Key, woodruff, #26, 3/16 x 2-1/8" long	377 to 416	1 oz.
5	K 586	Key, woodruff #19, 3/16 x 1-7/32" long (4 used)	377 to 416	1 oz.
6	K 1185	Set screw, 1/2 x 1" long (3 used)	377 to 416	1 oz.
7	0165 SRA 200072	Main cylinder center disc assembly (Order 200072)	377 to 416	3-1/2
8	0700 SR	Main cylinder shaft, 1-1/4" O.D. x 49-1/2" long	377 to 400	17-1/2
	01152 SR	Main cylinder shaft, 1-1/4" dia. x 49-1/4" long	403 to 416	
9	35 SR-1	Main cylinder head, right, 1-1/4" bore	377 to 416	11-1/2
10	0318 SRA	Third main cylinder bar assembly, with teeth 43-7/8" long (2 used). Bolt, machine, 3/8 x 1" (3 used)	377 to 416	10
11	0317 SRA	Second main cylinder bar assembly, with teeth 43-7/8" long (2 used). Bolt, machine, 3/8 x 1" (3 used)	377 to 416	10
12	0316 SRA	First main cylinder bar assembly, with teeth 43-7/8" long (2 used). Bolt, machine, 3/8 x 1" (3 used)	377 to 416	10
13	K 1895	Washer, 2" O.D., 1-9/32" I.D., 3/64" thick	377 to 416	1 oz.
14	K 1565	Bushing, steel backed bronze, 1-3/8" O.D., 1-1/4" I.D., 1-1/8" long (2 used)	377 to 386	2 oz.
	K 2918	Bearing, fiber 1-7/16" O.D., 1-1/4" I.D., 1-1/4" long	390 to 416	1 oz.
15	0574 SR-1	Keeper plate for right main cylinder bearing	377 to 416	1/2
		Bolt, machine, 5/16 x 1-1/2"		
		Bolt, carriage, 3/8 x 1-1/2" (2 used)		
16	0187 SR-1	Anti-wrap shield for cylinder, R.H.	377 to 416	3/4
		Bolt, machine, 5/16 x 1-1/2"		
		Bolt, machine, 5/16 x 1-3/4"		
17	K 624	Grease fitting, 1/8" pipe thread, 90 degree elbow	377 to 416	1 oz.
18	33 SRA	Main cylinder bearing assembly (with 2-K1565) Order 68 SRA	377 to 386	1-1/2
	68 SRA	Main cylinder bearing assembly (with 2-K2918)	390 to 416	1-1/2
19	K 1189	Set screw 1/2 x 1 1-1/4"	377 to 416	1 oz.
20	K 579	Jam nut, 1/2" hexagon (2 used)	377 to 416	1 oz.
21	65 SR	15 tooth sprocket for #62 chain, 1-1/4" bore	377 to 400	4-3/4
	117 SR	20 tooth sprocket for #2050 roller chain, 1-1/4" bore	403 to 416	4-1/4
22	78 SR	20 tooth drive sprocket for #62 chain, 1-1/4" bore	377 to 400	8
	123 SR	26 tooth sprocket for #2050 roller chain, 1-1/4" bore	403 to 416	6-1/2

UPPER CYLINDER

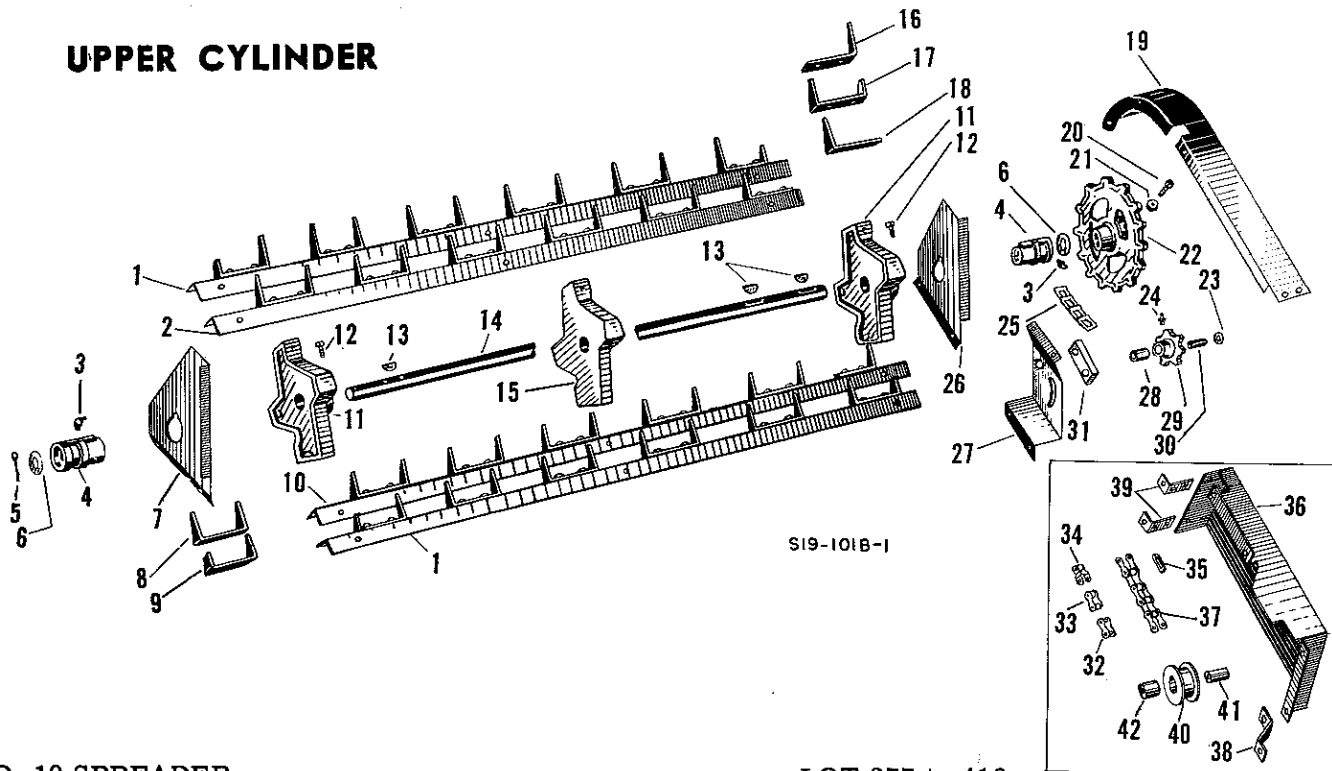

S19-101B-1

NO. 19 SPREADER

LOT 377 to 416

Ref.	Part No.	Description	Lot No.	Wt.Lbs.
1	0721 SRA	Upper cylinder bar assembly, with teeth 5/32 x 1-3/8 x 50-1/2" long (2 used).....	377 to 416	9
		Bolt, machine, 3/8 x 1" (3 used)		
2	0719 SRA	Upper cylinder bar assembly, with teeth 5/32 x 1-3/8 x 1-3/8 x 50-1/2" long.....	377 to 416	9
		Bolt, machine, 3/8 x 1" (3 used)		
3	K 615	Grease fitting, 1/8" pipe thread, 45 degree elbow (2 used).....	377 to 416	1 oz.
4	L 363	Bearing, 1" bore for upper cylinder (2 used).....	377 to 416	4
5	K 1107	Cotter pin, 5/16 x 1-1/4".....	377 to 416	1 oz.
6	K 873	Washer, 1-3/4" O.D., 1-1/32" I.D., 1/16" thick (2 used).....	377 to 416	1 oz.
7	0718 SR	Left upper cylinder bearing bracket, 10 ga.	377 to 416	3-3/4
		Bolt, machine, 3/8 x 1" (2 used)		
8	0312 SR	Cylinder tooth 1/4 x 1-1/4" flat, 10-1/16" long (18 used).....	377 to 416	1/2
		Rivet, button head, 5/16 x 7/8" (2 used)		
9	0722 SR	Short cylinder tooth, 1/4 x 1-1/4 x 8-7/8" long (L.H.) (2 used).....	377 to 416	1/2
		Rivet, button head, 5/16 x 7/8" (2 used)		
10	0720 SRA	Upper cylinder bar assembly, with teeth 5/32 x 1-3/8 x 50-1/2" long.....	377 to 416	9
		Bolt, machine, 3/8 x 1" (3 used)		
11	48 SR	Upper cylinder head (2 used).....	377 to 416	4
12	K 1185	Set screw, 1/2 x 1" for cylinder heads (2 used).....	377 to 416	1 oz.
13	K 589	Key, woodruff, #13, 3/16 x 1" (3 used).....	377 to 416	1 oz.
14	0716 SR	Upper cylinder shaft, 1" O.D., 58-1/8" long.....	377 to 400	9
	01153 SR	Upper cylinder shaft, 1" O.D., 58-1/8" long.....	403 to 416	9
15	74 SR	Upper cylinder head - center (Order 201694).....	377 to 416	4
	201694	Upper cylinder head - center.....	---	---
16	0155 SR	Single cylinder tooth, 1/4 x 1-1/4" flat, 6-7/8" long (left).....	377 to 416	1/2
		Rivet, button head, 5/16 x 7/8" (2 used)		
17	0723 SR	Short cylinder tooth, 1/4 x 1-1/4 x 8-7/8" long (R.H.) (2 used).....	377 to 416	1/2
18	0154 SR	Single cylinder tooth, 1/4 x 1-1/4" flat, 6-7/8" long (right).....	377 to 416	1/2
		Rivet, button head, 5/16 x 7/8" (2 used)		
19	0816 SR	Upper cylinder drive chain shield, Order 0927 SR.....	377 to 386	2
	0927 SR	Upper cylinder drive chain shield.....	390 to 408	2
		Machine screw, 5/16" x 3/4" (3 used)		
		Machine screw, 1/4 x 1/2" (2 used)		
20	K 1189	Set screw, 1/2 x 1-1/4" for drive sprocket.....	377 to 416	1 oz.
21	K 579	Jam nut, 1/2".....	377 to 416	1 oz.
22	86 SR	14 tooth sprocket, for upper cylinder, 1" bore #62 chain.....	377 to 400	4-1/2
	114 SR	19 tooth sprocket, for upper cylinder, 1" bore #2050 chain.....	403 to 416	4-1/2
	L 548	12-tooth sprocket, for upper cylinder 1" bore #2050 chain.....	---	---

UPPER CYLINDER (CON'T)

Ref.	Part No.	Description	Lot No.	Wt. Lbs.
23	K 847	Washer, 1-1/2" O.D., 21/32" I.D., 3/32" thick.....	377 to 416	1 oz.
24	K 626	Grease fitting, 1/4" pipe thread, straight.....	377 to 416	1 oz.
25	62	Steel chain link (complete chain 43 links).....	377 to 416	2 oz.
26	0717 SR	Right upper cylinder bearing bracket, 10 ga..... Bolt, machine, 3/8 x 1" (2 used)	377 to 416	3-3/4
27	0693 SRA	Upper cylinder chain tightener bracket assembly..... Bolt, machine, 3/8 x 3/4" (2 used) Bolt, carriage, 3/8 x 1-1/4" (2 used)	377 to 416	3
28	K 3103	Bushing, fiber, 1-1/8" O.D., 29/32" I.D., 2" long.....	377 to 400	1/4
29	77 SRA	7 tooth tightener sprocket, (with 1 K 3103 bearing) 57/64" I.D.....	377 to 400	2-1/2
30	0695 SR	Spacer in chain tightener sprocket, 51/64" O.D., 5/8" I.D., 2-1/2" long.....	377 to 400	1/4
31	0698 SR	Chain tightener block, 5/8 x 2 x 5-1/2" long.....	377 to 416	2
32	K 2569 A	Connector link, 1-1/4 pitch for #2050 roller chain.....	403 to 416	1 oz.
33	K 2568	Roller link, 1-1/4 pitch for #2050 roller chain.....	403 to 416	1 oz.
34	K 2570	Offset link, 1-1/4 pitch for #2050 roller chain.....	403 to 416	1 oz.
35	K 3723	Spring clip for 1-1/4 extended pitch #2050 roller chain.....	403 to 416	1 oz.
36	A 01179 SR	Upper cylinder drive chain shield with two angle brackets.....	411 to 416	4 oz.
37	0933 SRA	Upper cylinder roller drive chain assembly #2050 chain 57 total links.....	403 to 416	2-1/2 oz.
38	01180 SR	Lower bracket for upper cylinder chain shield.....	411 to 416	2 oz.
39	01196 SR	Upper bracket for upper cylinder drive chain shield.....	411 to 416	2 oz.
40	118 SRA	Idler roller (with 1 - K 3214 bushing) 57/64" I.D.....	403 to 416	1-1/4 oz.
41	K 3626	Spacer for idler roller, 7/8" O.D., x 1-13/16" long.....	403 to 416	1/4 oz.
42	K 3214	Bushing, fiber for idler roller, 1" O.D., x 29/38" I.D., x 1-1/2" long.....	403 to 416	1 oz.

DISTRIBUTER

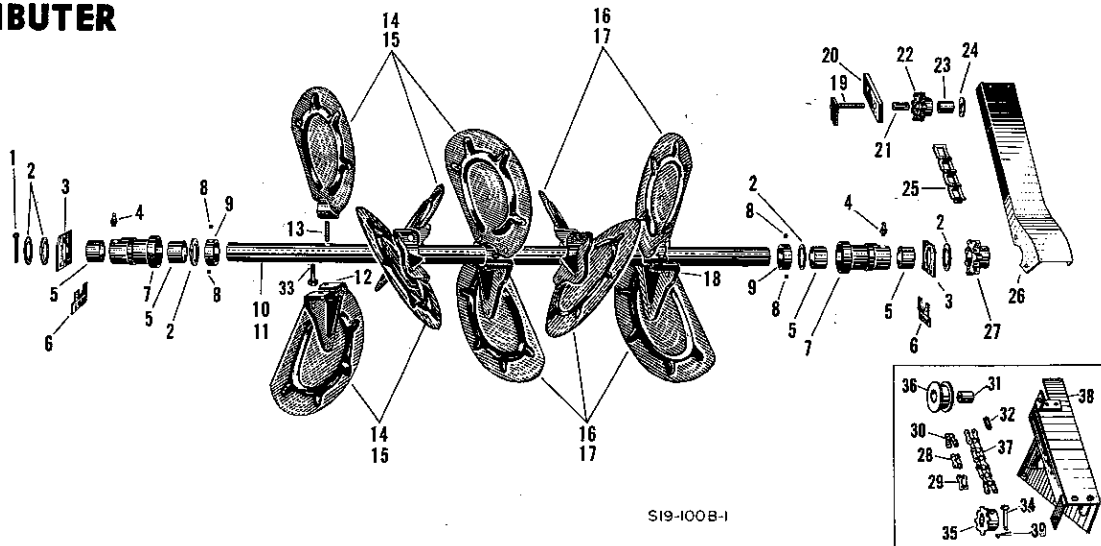

NO. 19 SPREADER

LOT 377 to 416

Ref.	Part No.	Description	Lot No.	Wt. Lbs.
1	K 1096	Cotter pin, 1/4 x 2".....	377 to 416	1 oz.
2	K 1786	Washer, on distributor shaft, 2-1/2" O.D., 1-21/32" I.D., 3/32" thick (5 used).....	377 to 416	1 oz.
3	0673 SR	Distributor bearing plate, 1/4 x 4 x 4-3/4" (2 used).....	377 to 416	3/4
4	K 1728	Grease fitting, 1/4" pipe thread 90, Order K-626 (2 used).....	377 only	1 oz.
	K 626	Grease fitting, 1/4" pipe thread, straight (2 used).....	381 to 416	1 oz.
5	K 1841	Bushing, fiber, 1-7/8" O.D., 1-5/8" I.D., 1-1/4" long, for distributor bearing (4 used).....	377 to 416	2 oz.
6	0574 SR 1	Keeper plate for distributor bearing (2 used)..... Bolt, machine, 3/8 x 2" (2 used)	377 to 416	1/4
7	72 SRA	Bearing assembly, with two K-1841 bushings (2 used).....	377 to 416	2
8	K 1349	Set screw for locking collar, 5/16 x 3/8" (4 used).....	377 to 416	1 oz.

DISTRIBUTER (CON'T)

Ref.	Part No.	Description	Lot No.	Wt. Lbs.
9	73 SR	Distributor shaft locking collar (2 used)	377 to 416	1/2
	155 SRA	Wiper arm assembly (right)	---	---
	156 SRA	Wiper arm assembly (left)	---	---
10	0672 SRA	Distributor, complete	377 to 400	73-1/2
	01150 SRA	Distributor, complete	403 to 416	73-1/2
11	0672 SR	Distributor shaft, 1-5/8" x 53-1/8" long	377 to 400	4-1/2
	01150 SR	Distributor shaft, 1-39/64 x 53-3/8" long	403 to 416	4-1/2
12	71 SR	Distributor paddle casting, left	377 to 416	2-3/4
13	0604 SR	Drive pin for distributor paddle, 3/8 x 2-5/16" (5 used)	377 to 416	1 oz.
14	0571 SRA 1	Distributor paddle with casting, L.H., 13 ga. (5 used)	377 to 416	5-1/4
		Bolt, machine, 3/8 x 1-1/2" (2 used)		
15	0571 SR 1	Distributor paddle, left	377 to 416	2-1/4
		Rivet, button head, 3/8" x 1"		
16	0572 SRA 1	Distributor paddle with casting, R.H., 13 ga. (5 used)	377 to 416	5-1/4
		Bolt, machine, 3/8 x 1-1/2" (2 used)		
17	0572 SR 1	Distributor paddle, right	377 to 416	2-1/4
		Rivet, button head, 3/8 x 1"		
18	70 SR	Distributor paddle casting, right	377 to 416	2-3/4
19	0706 SRA	Distributor chain tightener stud assembly, 5/8 x 3-1/2" long	377 to 400	1/2
	01151 SRA	Distributor chain tightener stud assembly, 5/8 x 3-1/2" long	403 to 416	1/2
20	0698 SR	Chain tightener block, 5/8 x 2 x 5-1/2"	377 to 416	1/4
21	0695 SR	Spacer in chain tightener sprocket, 7/8" O.D., 5/8" I.D., 2-1/2" long	377 to 400	1/4
22	77 SRA	7-tooth tightener sprocket (with 1 K-3103 bearing) 57/64" I.D.	377 to 400	1-1/4
23	K 3103	Bushing, fiber, 1-1/8" O.D., 29/32" I.D., 2" long	377 to 400	1 oz.
24	K 847	Washer, 1-1/2" O.D., 21/32" I.D., 3/32" thick	377 to 400	1 oz.
25	62	Steel chain link (complete chain, 42 links)	377 to 400	2 oz.
26	0817 SRA	Distributor drive chain shield	377 to 408	1-3/4
		Bolt, carriage, 5/16 x 3/4" (2 used)		
27	81 SR	7-tooth sprocket on distributor for #62 chain, 1-5/8" bore	377 to 400	2-1/2
		Rivet, button head, 3/8 x 2-1/2"		
28	K 2568	Roller link, 1-1/4" pitch for #2050 roller chain	403 to 416	1 oz.
29	K 2569 A	Connector link, 1-1/4" pitch for #2050 roller chain	403 to 416	1 oz.
30	K 2570	Offset link, 1-1/4" pitch for #2050 roller chain	403 to 416	1 oz.
31	K 3214	Bushing, fiber, 1" O.D., 29/32" I.D., 1-1/2" long for idler	403 to 416	1 oz.
32	K 3723	Spring clip, for 1-1/4" extended pitch #2050 roller chain	403 to 416	1 oz.
33	K 4416	Bolt, machine, 3/8 x 1-1/2" hardened for distributor paddle	403 to 416	1 oz.
34	593 P	Drilled rivet, 3/8 x 2-5/8"	403 to 416	2 oz.
35	115 SR	9-tooth drive sprocket for #2050 roller chain, 1-5/8" bore (Order 115 SR1)	403 to 416	1-1/2 oz.
	115 SR1	9-tooth drive sprocket for #2050 roller chain, 1-5/8" bore	---	---
36	118 SRA	Idler roller (with (1) K 3214 bushing) 57/64" I.D.	403 to 416	1-1/4 oz.
37	01149 SRA	Distributor roller drive chain, 1-1/4" extended pitch #2050, 55 total links	403 to 416	2-1/2 oz.
38	01183 SRA	Distributor drive chain shield	411 to 416	2-1/4 oz.
39	K 1071	Cotter pin, 1/8 x 3/4"	403 to 416	1 oz.

GEAR CASE

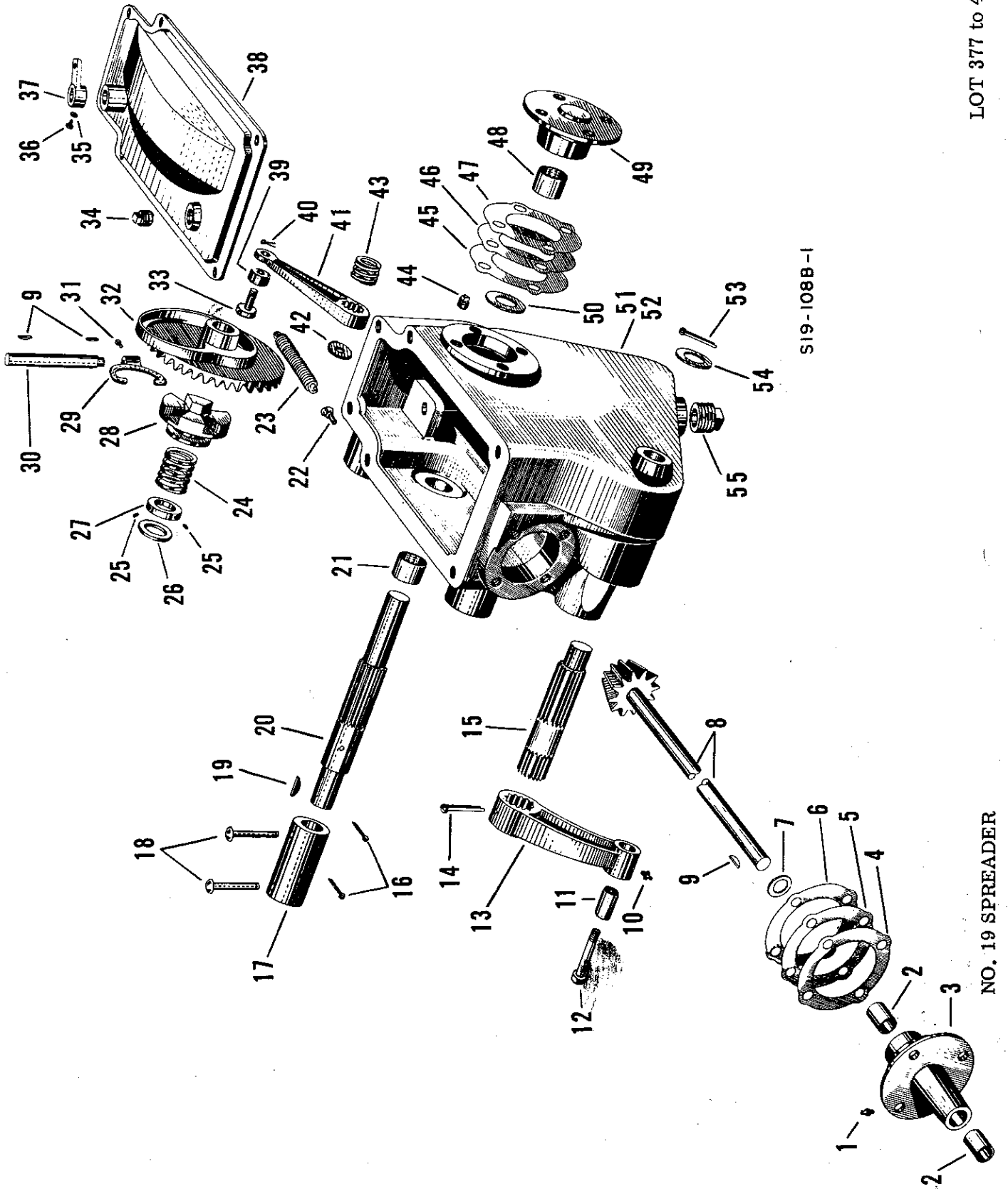

S19-108B-1

LOT 377 to 416

NO. 19 SPREADER

GEAR CASE (CONT)

Ref.	Part No.	Description	Lot No.	Wt. Lbs.
1	K 624	Grease fitting, 1/8" pipe thread, 90 degree elbow, Order K 626.....	377 only	1 oz.
	K 626	Grease fitting, 1/4" pipe thread (2 used).....	366 to 416	1 oz.
2	K 1867	Bushing - bronze steel backed, 1-1/4" O.D., 1-1/8" I.D., 1-1/4" long (2 used).....	377 to 416	1/4
3	92 SRA 200491	Bearing cap for pinion shaft with bushings K 1867 (Order 200491)..... Pinion shaft and cap assembly.....	377 to 416 ---	3-1/4 ---
		Bolt, machine, 3/8 x 1" less nuts (4 used)		
4	K 3116	Shim 3-3/4" O.D., 3-1/32" I.D., .005" thick.....	377 to 416	1 oz.
5	K 3115	Shim, 3-3/4" O.D., 3-1/32" I.D., .007" thick.....	377 to 416	1 oz.
6	K 3114	Shim, 3-3/4" O.D., 3-1/32" I.D., .020" thick.....	377 to 416	1 oz.
7	K 1777	Washer, 2" O.D., 1-5/32" I.D., 1/16" thick.....	377 to 416	2 oz.
8	0766 SRA	13 tooth, bevel pinion and shaft.....	377 to 416	7
9	K 589	Key, #13 Woodruff, 3/16 x 1" (3 used).....	377 to 416	1 oz.
10	K 626	Grease fitting, 1/4" pipe thread.....	377 to 416	1 oz.
11	0780 SR	Bushing, 3/4" O.D., 17/32" I.D., 1-3/4" long.....	377 to 416	2 oz.
12	K 3133	Bolt, machine, 1/2 x 2-3/4" hex. hd. hardened.....	377 to 416	1/4
13	96 SR	Feed drive arm.....	377 to 416	2
14	K 1097	Cotter pin, 1/4 x 2-1/4".....	377 only	1 oz.
	K 2074	Cotter pin, 1/4 x 2-3/4".....	386 to 416	1 oz.
15	0771 SR	Feed arm shaft, 1-1/4" rd. x 6-7/8" long, 19 tooth spline (Order 0771 SR 3).....	377 to 408	4-3/4
	A 0771 SR 2	Feed arm shaft, Order 0771 SR 3.....	411 only	4-3/4
	0771 SR 3	Feed arm shaft.....	416 only	4-3/4
16	K 1071	Cotter pin, 1/8 x 3/4" (2 used).....	377 to 416	1 oz.
17	0699 SR	Coupling for main cylinder shaft, 2-1/4" O.D., 1-1/4" I.D., x 4-3/4" long (Order 200071).....	377 to 416	2-1/2
	200071	Coupling for main cylinder shaft, 2-1/4" O.D., 1-1/4" I.D., x 4-3/4" long.....	---	---
18	K 1864	Rivet, for coupling, drilled, 3/8 x 2-1/2" (2 used).....	377 to 416	2 oz.
19	K 587	Key, #26 Woodruff, 3/16 x 2-1/8".....	377 to 416	1 oz.
20	0768 SR	Main cross shaft for gear case, Order 0768 SR 1.....	377 to 390	2-1/2
	0768 SR 1	Main cross shaft for gear case.....	396 to 416	2-1/2
21	K 3108	Bushings - bronze steel backed, 1-5/8" O.D., 1-1/2" I.D., 2" long.....	377 to 416	1/4
22	K 3112	Thumb, screw, 5/16 x 1/2" drilled, 1/8" hole.....	377 to 416	2 oz.
23	246 LS	Extension spring for cam follower arm, 38 coil, 4-1/2" long, Order K 4023.....	377 to 396	2 oz.
	K 3780	Extension spring for cam follower arm, 3/4" O.D., 4-5/8" long, 34 coils, Order K 4023.....	398 only	2 oz.
	K 4023	Extension spring.....	403 to 416	
24	K 3109	Compression spring, 1-5/8" I.D., 2-1/2" long, 5 coils.....	377 to 416	1/4
25	K 2142	Set screw, Allen head, 1/4 x 3/8" (2 used).....	377 to 416	1 oz.
26	K 3733	Washer, 2-1/4" O.D., 1-17/32" I.D., 1/16" thick.....	377 to 416	2 oz.
27	0769 SR	Set collar for clutch.....	377 to 416	2-1/2
28	93 SR	Clutch jaw sliding half.....	377 to 416	2-1/2
29	94 SR	Clutch shifter fork.....	377 to 416	2
30	0770 SR	Clutch throwout shaft, 3/4" O.D., x 7-5/8" long.....	377 to 416	2-1/2
31	K 1729	Set screw for shifter fork, 5/16 x 3/8" hollow hd.....	377 to 416	1/4
32	76 SR	38-tooth, bevel gear and feed cam (Order 200461).....	377 to 416	11-1/2
	200461	38-tooth bevel gear and feed cam.....	---	---
33	0772 SR	Pin for cam roller, 1-13/16 x 3/4" drilled, Order 97 SRA-1, See Key 41.....	377 to 400	2 oz.
34	K 718	Pipe plug, 1/2".....	377 to 416	1 oz.
35	K 578	3/8" hex. jam nut.....	377 to 416	1 oz.
36	K 1158	Set screw, 3/8 x 3/4" reg. sq. hd.....	377 to 416	1 oz.
37	95 SR	Clutch shifter arm.....	377 to 416	1/2
38	98 SR	Cover for gear case.....	377 to 416	7
	200345	Cover for gear case.....	---	---
39	0773 SR	Cam roller, 1-3/8" O.D., x 3/4" I.D., heat treated.....	377 to 400	1/4
	01148 SR	Cam roller bearing.....	403 to 416	
40	K 1082	Cotter pin, 3/16 x 1-1/4".....	377 to 416	1 oz.
41	97 SRA	Cam follower arm with roller and pin, Order 97 SRA-2.....	377 to 400	2
	97 SRA 1	Cam follower arm with roller and pin, Order 97 SRA-2.....	403 to 411	2
	97 SRA 2	Cam follower arm with roller and pin, Order 202164.....	416 only	2
	202164	Cam follower arm with roller and pin.....	---	---
42	K 1780	Washer, 2" O.D., 1-9/32" I.D., 3/32" thick.....	366 to 416	1 oz.
43	K 3111	Spring compression, 1-5/8" O.D., 1-5/8" long, 3 coils.....	377 to 416	2 oz.
44	K 1336	Pipe plug, 1/8".....	377 to 416	1 oz.
45	K 1814	Shim, 3-1/2" O.D., 2-25/32" I.D., .005" thick, use as required.....	377 to 416	1 oz.
46	K 1815	Shim, 3-1/2" O.D., 2-25/32" I.D., .007" thick, use as required.....	377 to 416	1 oz.
47	K 1816	Shim, 3-1/2" O.D., 2-25/32" I.D., .020" thick, use as required.....	377 to 416	1 oz.
48	K 1614	Bushings, steel backed bronze, 1-3/8" O.D., 1-1/4" I.D., 1-1/2" long.....	377 to 416	1/4
49	91 SRA	Bearing cap for driven shaft with bushing.....	377 to 416	5
		Bolt, machine, 3/8 x 1" less nuts (4 used)		
50	K 1781	Washer, 2-3/8" O.D., x 1-9/32" I.D., x 1/16" thick.....	377 to 416	2 oz.
51	90 SRA	Gear case assembly, Order 90 SRA-2.....	377 to 390	41
	90 SRA 1	Gear case assembly, Order 90 SRA-2.....	396 to 411	41
	90 SRA 2	Gear case assembly.....	416 only	41
		Bolt, machine, 3/8 x 1" (4 used)		
52	A 90 SRA	Gear case complete, Order A 90 SRA-2.....	379 to 390	87
	A 90 SRA 1	Gear case complete, Order A 90 SRA-2.....	396 to 408	87
	A 90 SRA 2	Gear case complete.....	416 only	87
53	K 1073	Cotter pin, 1/8 x 1-1/4".....	377 to 416	1 oz.
54	K 3110	Washer, 1-5/8" O.D., 31/32" I.D., 1/16" thick.....	377 to 416	2 oz.
55	K 2224	Pipe plug, 1".....	377 to 416	2 oz.

FEED SHAFT AND CONVEYOR

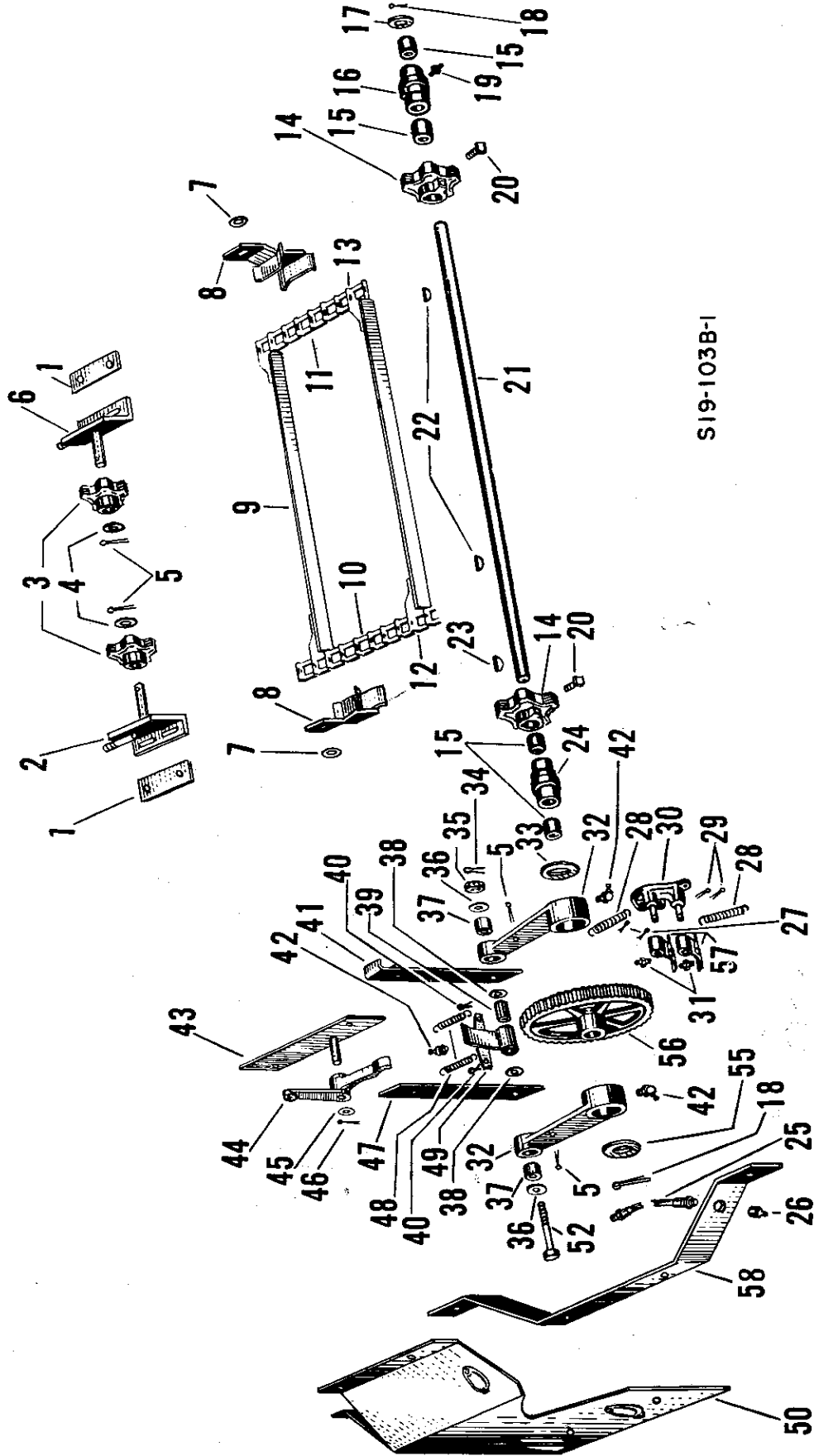

S19-103B-1

LOT 377 to 390

NO. 19 SPREADER

FEED SHAFT AND CONVEYOR (CON'T)

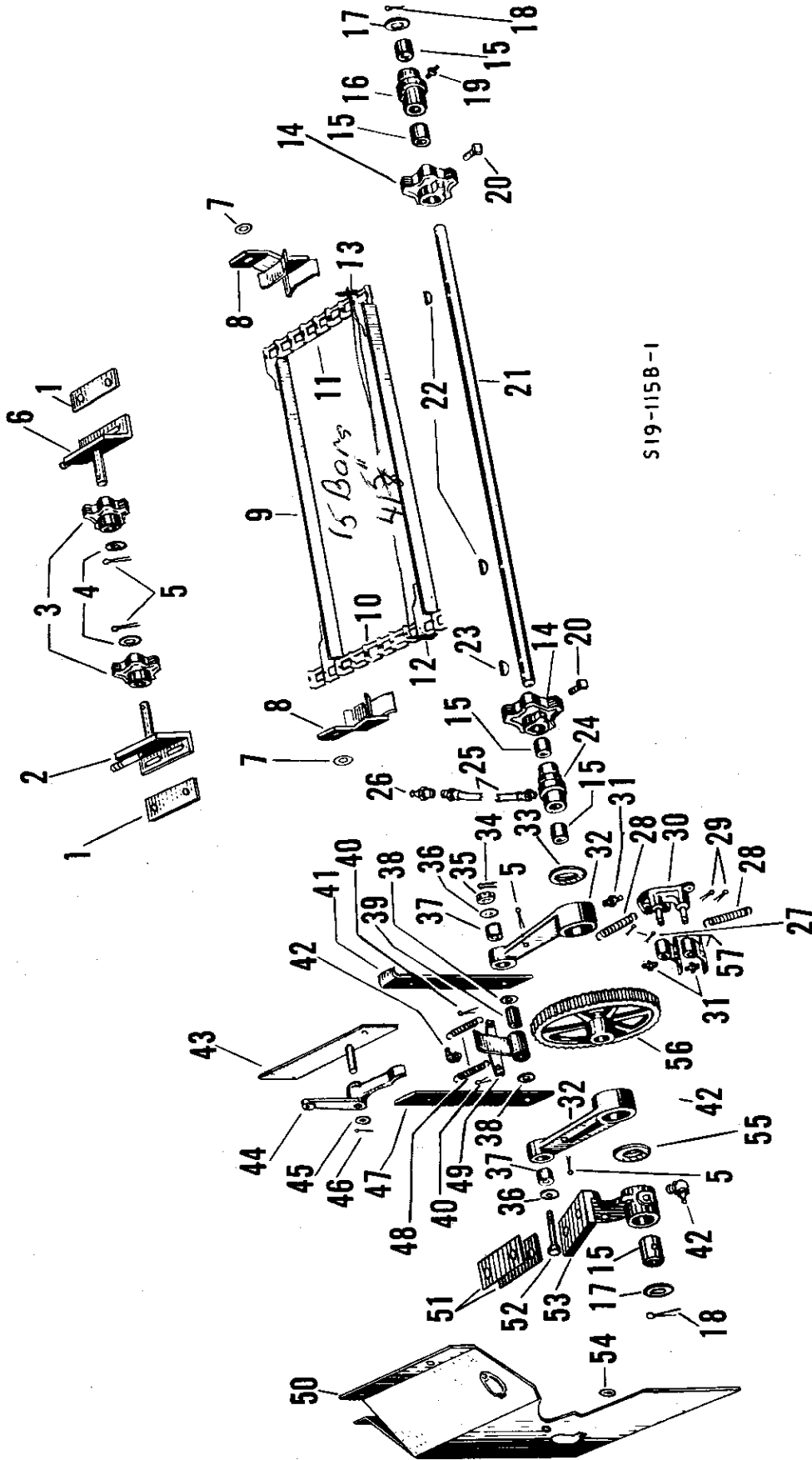

S19-115B-1

LOT 396 to 416

NO. 19 SPREADER

FEED SHAFT AND CONVEYOR (CON'T)

Ref.	Part No.	Description	Lot No.	Wt.Lbs.
1	0413 SR	Strap, for conveyor idler bracket, 3/16 x 1" flat, 4" long (2 used), Order 0413 SR 1.....	377 to 390	1/4
2	0413 SR 1	Strap for conveyor idler bracket, 3/16 x 1" flat, 4" long (2 used).....	396 to 416	1/4
	0724 SRA	Front conveyor tightener bracket assembly, left, Order 0724 SRA 1	377 to 390	1-3/4
3	0724 SRA 1	Front conveyor tightener bracket assembly, left.....	396 to 416	1-3/4
	L 473	Bolt, carriage, 7/16 x 1-1/4" (2 used)		
4	K 847	5 tooth, idler sprocket for #67 or #77 chain (2 used).....	377 to 416	2-1/2
5	K 1081	Washer, 1-1/2" O.D., x 21/32" I.D., 3/32" thick (2 used).....	377 to 416	1 oz.
6	0725 SRA	Cotter pin, 3/16 x 1" (4 used).....	377 to 416	1 oz.
	0725 SRA 1	Front conveyor tightener bracket assembly, right, Order 0725 SRA 1	377 to 390	1-3/4
7	0725 SRA 1	Front conveyor tightener bracket assembly, right.....	396 to 416	1-3/4
	K 2880	Bolt, carriage, 7/16 x 1-1/4" (2 used)		
8	0838 SRA	Washer, 1" O.D., 7/16" I.D., 1/16" thick (2 used).....	377 to 416	1 oz.
9	0680 SRA	Conveyor slide assembly (2 used).....	377 to 416	1-1/2
	01157 SRA	Bolt, machine, 3/8 x 1"		
10	0680 SRA	Conveyor bar assembly with attachment link, 1-3/4" x 1" x 3/16" angle (15 used).....	377 to 400	6-1/2
	01157 SRA	Conveyor bar assembly with attachment links 1-3/4" x 1" x 3/16" angle (15 used).....	403 to 416	2 oz.
11	77	Plain steel chain link (200 used), Order 67H.....	377 to 400	2 oz.
	67H	Plain steel chain link (200 used).....	403 to 416	2 oz.
12	0677 SRA	Conveyor chain assembly, with (15) 0680 SRA bars; (220) #77 steel links; (15) 77 ARS; and (15) 77 ALS attachment links. Assemble 1 bar followed by 6 plain links and 2 bars followed by 4 plain links, then 12 bars followed by 7 plain links, Order 01156 SRA.....	377 to 400	140
	01156 SRA	Conveyor chain assembly with (15) 01157 SRA bars; (200) #67 H steel links; (15) 67H ARS; and (15) 67H-ALS attachment links, assemble 10 bars followed by 7 plain links, then 5 bars followed by 6 plain links.....	403 to 416	120
13	77 ARS	Steel attachment link, left (15 used), Order 67 HARS.....	377 to 400	3 oz.
	67 HARS	Steel attachment link, left (15 used).....	403 to 416	3 oz.
14	77 ALS	Rivet, flat head, 5/16 x 5/8"		
	67 HALS	Steel attachment link, right (15 used), Order 67 HALS.....	377 to 400	3 oz.
15	67 HALS	Steel attachment link, right (15 used).....	403 to 416	3 oz.
	Rivet, flat head 5/16 x 5/8"			
16	23 SR	6 tooth feed shaft sprocket, 1-3/16" bore for #67 or #77 chain (2 used), Order 23 SR-1.....	377 to 411	1
	23 SR 1	6 tooth feed shaft sprocket, 1-3/16" bore for #67 or #77 chain (2 used).....	416 only	1
17	K 1842	Bearing, fiber, 1-7/16" O.D., 1-3/16" I.D., 1-1/2" long (5 used)....	377 to 416	1 oz.
18	19 SRA	Feed shaft bearing assembly, right (with two K 1842 bushings).....	377 to 416	2-1/2
19	K 886	Washer, 1-7/8" O.D., x 1-7/32" I.D., 1/16" thick (2 used).....	377 to 416	1 oz.
20	K 1084	Cotter pin, 3/16 x 1-3/4" (2 used).....	377 to 416	1 oz.
21	K 626	Grease fitting, 1/4" - 28 thread, straight.....	377 to 416	1 oz.
22	K 1158	Set screw, 3/8 x 3/4" (2 used).....	377 to 416	1 oz.
23	0740 SR	Feed shaft, 1-3/16" Rd., 54-13/16" long.....	377 to 390	17
	0986 SR	Feed shaft, 1-3/16" Rd., 56-3/8" long.....	396 to 416	18
24	K 1577	Key for feed sprocket, No. 19 Woodruff, 1/4 x 1-1/8" (2 used).....	377 to 416	1 oz.
25	K 600	Key for feed shaft, No. 20 Woodruff, 7/32" x 1-1/4".....	377 to 416	1 oz.
26	89 SRA	Feed shaft bearing assembly, left (with two K 1842 bushings).....	377 to 416	2-1/2
27	K 2587	Grease line, 15" long for 89 SRA bearing.....	377 to 416	1/4
28	K 625	Grease fitting, 1/8" female pipe thread.....	377 to 416	1 oz.
29	K 1082	Cotter pin, 3/16 x 1-1/4" (2 used).....	377 to 416	1 oz.
30	K 3127	Spring extension, 26 coils, 2-1/8" long, Order K 4063.....	377 to 400	2 oz.
31	K 4063	Spring extension, 21 coils, 2-1/4" long.....	403 to 416	2 oz.
	K 1091	Cotter pin, 1/4 x 3/4" (2 used).....	377 to 416	1 oz.
32	104 SRA	Retention pawl bracket assembly.....	377 to 416	6
	K 621	Bolt, machine, 3/8 x 1-1/2" (2 used)		
33	99 SR	Grease fitting, 1.8" pipe thread, straight (3 used).....	377 to 416	1 oz.
34	K 3105	Feed arm (2 used).....	377 to 416	3
35	K 1073	Washer, 2-3/4" O.D., 2-5/32" I.D., 3/32" thick.....	377 to 416	1 oz.
36	K 2230	Cotter pin, 1/8 x 1-1/4".....	396 to 416	1 oz.
37	K 3122	Nut 1/2", slotted.....	396 to 416	1 oz.
38		Washer, 1-1/2" O.D., 29/32" I.D., 3/16" thick (2 used).....	377 to 416	1 oz.

FEED SHAFT AND CONVEYOR (CON'T)

Ref.	Part No.	Description	Lot No.	Wt.Lbs.
37	K 3123	Spacer for feed arm, 7/8" O.D., x 1/2" long (2 used)	377 to 416	2 oz.
38	K 2248	Washer, 1-1/8" O.D., 17/32" I.D., 1/8" thick (2 used)	377 to 416	1 oz.
39	K 3124	Spacer for feed pawl, 7/8" O.D., 1-3/4" long.....	377 to 416	3 oz.
40	K 1951	Cotter pin, 1/8 x 1/2" (2 used)	386 to 416	1 oz.
41	0775 SRA	Feed drive link, 1/4 x 1-1/2" x 10-13/16" long, right.....	377 to 416	1-1/2
42	K 624	Grease fitting, 1/8" pipe thread, 90 degree elbow (3 used)	377 to 416	1 oz.
43	0819 SRA	Feed adjustment arm bracket assembly..... Bolt, carriage, 3/8 x 1-1/4" bastard hd. Bolt, carriage, 3/8 x 1-1/4" bastard hd. (2 used)	377 to 416	4
44	103 SR	Feed arm stop	377 to 416	2
45	K 1766	Washer, 1-1/2" O.D., 25/32" I.D., 1/16" thick.....	377 to 416	1 oz.
46	K 1072	Cotter pin, 1/8 x 1".....	377 to 416	1 oz.
47	0774 SR	Feed drive link, 1/4 x 1-1/2" x 10-1/8" long, left.....	377 to 416	1-1/4
48	K 1827	Spring, extension, 29 coils, 2-1/8" long, Order K 4063.....	377 to 400	2 oz.
	K 4063	Spring, extension, 2-1/4" long	416 only	
49	0836 SRA	Feed pawl assembly.....	377 to 416	1-1/4
50	0849 SRA	Ratchet shield assembly, Order 0849 SRA-1	377 only	7
	0849 SRA 1	Ratchet shield assembly	386 to 390	7
		Bolt, machine, 3/8 x 3/4" (2 used) Bolt, carriage, 3/8 x 1-1/4" bastard hd. (2 used)		
	0988 SRA	Ratchet shield assembly	396 to 416	7
		Bolt, machine, 3/8 x 1" (2 used) Bolt, carriage, 3/8 x 1-1/4" (3 used)		
51	0987 SR	Shim for outboard bearing, 1/16 x 2-3/4" flat, 3-1/4" long (2 used).	396 to 416	2 oz.
52	K 3132	Bolt, machine, 1/2 x 4-1/4" hex. hd. (hardened) for feed drive link.	377 to 416	1/4
53	120 SRA	Outboard feed shaft bearing with bushing K 1842	396 to 416	3
		Bolt, machine, 1/2 x 1-1/4" (2 used)		
54	K 813	Washer, 1" O.D., 13/32" I.D., 1/8" thick.....	396 to 416	1 oz.
55	K 3106	Washer, 3" O.D., 1-7/32" I.D., 3/32" thick.....	377 to 416	1 oz.
56	106 SR	72 tooth ratchet feed wheel, 1-3/16" bore.....	377 to 400	13-1/2
	124 SR	90 tooth ratchet feed wheel, 1-3/16" bore.....	403 to 416	15
57	0837 SRA	Retention pawl assembly (2 used)	377 to 416	3/4
58	0850 SR	Ratchet shield, side brace	377 to 390	3-3/4
		Bolt, machine, 3/8 x 1" (2 used)		

MAIN DRIVE SHAFT ASSEMBLY

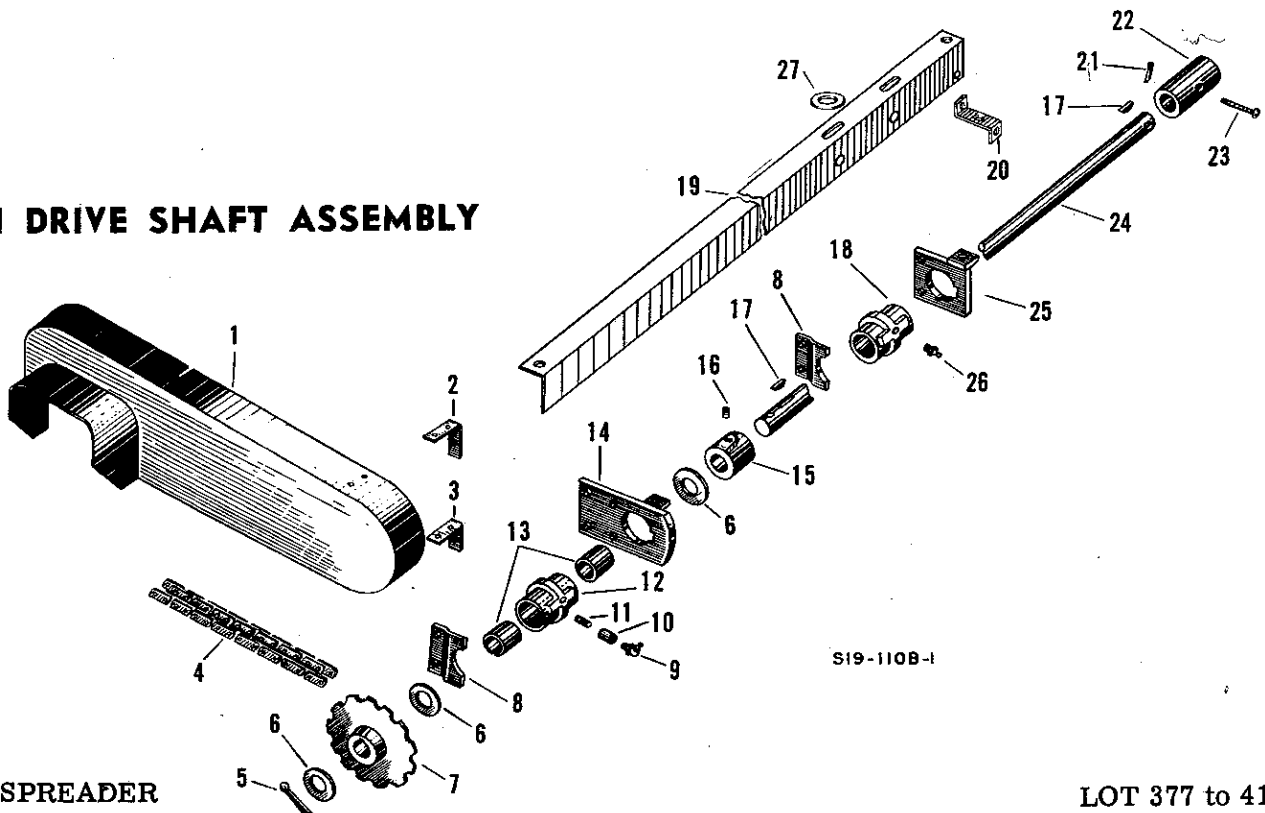

NO. 19 SPREADER

LOT 377 to 416

MAIN DRIVE SHAFT ASSEMBLY

Ref.	Part No.	Description	Lot No.	Wt. Lbs.
1	0840 SRA	Front chain shield assembly..... Bolt, machine, 3/8 x 3/4" (2 used) Bolt, machine, 5/16 x 3/4"	377 to 416	10-3/4
2	0843 SR	Upper front chain shield bracket, 1/8 x 1 x 3" long.....	377 to 416	1/4
3	0844 SR	Lower front chain shield bracket, 1/8 x 1 x 3-1/2" long..... Bolt, machine, 3/8 x 3/4"	377 to 416	1/4
4	0781 SRA	Roller chain assembly complete, 1-1/4" extended pitch (54 total links) (Order 098 WBA)	377 to 416	2-3/4
	098 WBA	Roller chain assembly complete	---	---
	K 2568	Roller link, 1-1/4" pitch, #2050	377 to 416	1 oz.
	K 2569 A	Connector 1-1/4" pitch, #2050.....	377 to 416	1 oz.
	K 2570	Offset link, 1-1/4" pitch, #2050.....	377 to 416	1 oz.
5	K 1083	Cotter pin, 3/16 x 1-1/2".....	377 only	1 oz.
	K 1094	Cotter pin, 1/4 x 1-1/2".....	386 to 416	1 oz.
6	K 1777	Washer, 2" O.D., 1-5/32" I.D., 1/16" thick on main drive shaft (3 used)	377 to 416	1 oz.
7	83 SR	13 tooth sprocket for #2050 chain.....	377 to 416	2-1/2
8	0712 SR	Keeper plate, for main drive shaft bearing (2 used)..... Bolt, machine, 5/16 x 1" (2 used)	377 to 416	1/2
9	K 623	Grease fitting, 1/8" pipe thread, 67-1/2 degree elbow.....	377 to 416	1 oz.
10	K 655	Pipe coupling, 1/8 x 3/4".....	377 to 390	2 oz.
11	K 636	Pipe nipple, 1/8 x 3/4".....	377 to 390	2 oz.
12	80 SRA	Front bearing main drive shaft (with 2 - K 3104 bushing).....	377 to 416	2
13	K 3104	Bushing, bronze, 1-25/64" O.D., 1-9/64" I.D., 1-1/8" long (2 used)	377 to 416	1/4
14	0732 SR	Bearing plate, for front bearing, 1/4 x 4 x 6", Order 0732 SRA.....	377 to 386	1-1/2
	0732 SRA	Bearing plate assembly for front bearing..... Bolt, machine, 3/8 x 1" (2 used)	390 to 416	1-1/2
15	79 SR	Stop collar for drive shaft bearing, 1-7/8" O.D., 1-9/64" I.D., 1" long.....	377 to 416	1/4
16	K 1169	Set screw in stop collar, 3/8 x 1/2".....	377 to 416	1 oz.
17	K 589	Key, #13 Woodruff, 3/16 x 1" for main drive shaft (2 used).....	377 to 416	1 oz.
18	82 SR	Center bearing main drive shaft, 1-9/64" I.D.....	377 to 416	2
19	0983 SR	Shield, main power shaft.....	390 to 416	2
20	0982 SR	Drive shaft shield bracket.....	390 to 416	1/2
21	K 1066	Cotter pin, 3/32 x 1/2".....	377 to 416	1 oz.
22	0711 SR	Coupling for main drive shaft, 2" O.D., 1-1/4" I.D., 4" long (Order 200066)	377 to 416	3
	200066	Coupling for main drive shaft.....	---	---
23	K 1629	Rivet, in shaft coupling, 1/4 x 2-1/4" (drilled).....	377 to 416	1 oz.
24	0710 SR	Main drive shaft, 1-1/8 x 127-5/8" long.....	377 to 416	35-1/2
25	0713 SR	Bearing plate for center bearing, 1/4 x 3 x 4-1/2", Order 0713 SRA	377 to 386	1-1/2
	0713 SRA	Bearing plate assembly for center bearing..... Bolt, machine, 5/16 x 1" (2 used)	390 to 416	1
26	K 621	Grease fitting, 1/8" pipe thread straight.....	377 to 416	1 oz.
27	K 2879	Washer, 7/8" O.D., 3/8" I.D., 3/64" thick, electro galv.....	390 to 416	1 oz.

P.T.O. DRIVE BEARING AND BRACKETS

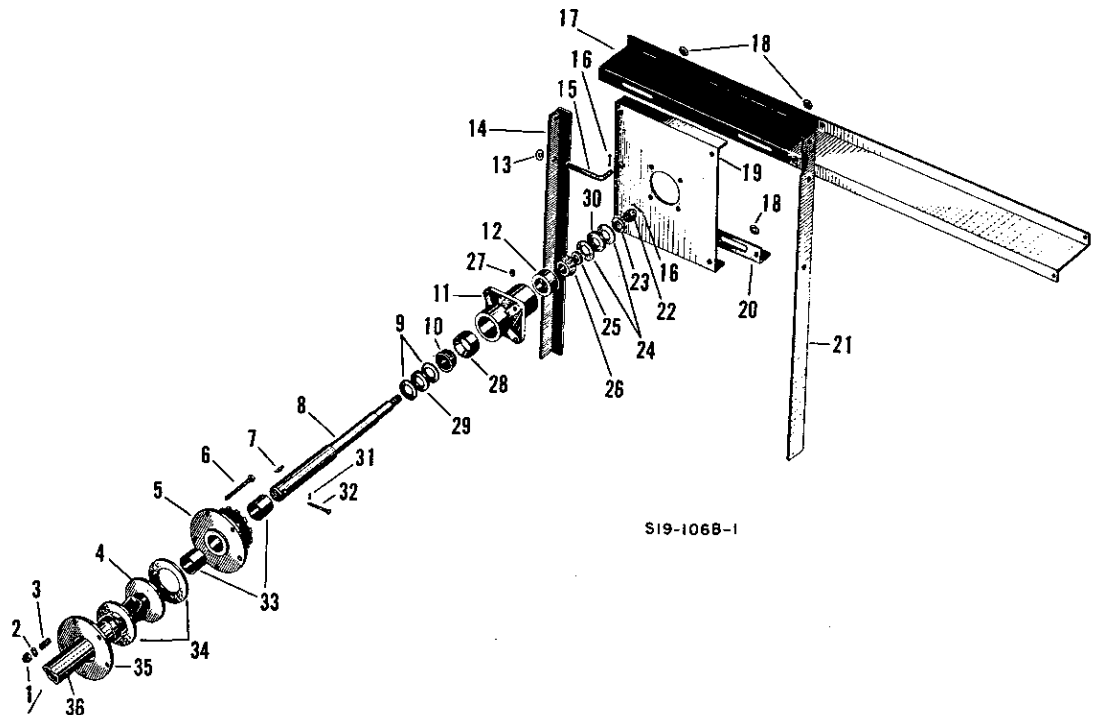

NO. 19 SPREADER

LOT 377 to 416

Ref.	Part No.	Description	Lot No.	Wt.Lbs.
1	K 2177	Nut, 3/8" Hex. slotted (5 used)	377 to 416	1 oz.
2	K 813	Washer, 1" O.D., 13/32" I.D., x 1/8" thick (5 used)	377 to 416	1 oz.
3	049 HS 1	Spring, compression, 1-1/16" O.D., 1-13/16" long, 5 coils (5 used)	377 to 416	2 oz.
4	0805 SRA	Clutch plate and yoke assembly	377 to 416	30
5	101 SRA	Clutch sprocket assembly (with 2 K-3113 bushing)	377 to 416	7-1/2
6	K 3120	Bolt, machine, 3/8 x 3-1/2" (drilled) (5 used)	377 to 416	2 oz.
7	K 590	Key, No. 18 Woodruff, for P.T.O. shaft, 1/4 x 1-1/8"	377 to 416	2 oz.
8	0782 SR	P.T.O. bearing shaft, 1-1/4" x 10" long	377 to 416	2-1/2
9	K 1781	Washer, 2" O.D., x 1-9/32" I.D., 1-1/16" thick (2 used)	377 to 416	1 oz.
10	K 1855	Tapered roller bearing cone, 1" I.D.	377 to 416	1 oz.
11	41 SRA	Bearing housing assembly Bolt, machine, 3/8 x 1-1/4" (4 used)	377 to 416	3-1/2
12	K 1818	Tapered roller bearing cup, 1-15/16" O.D.	377 to 416	1 oz.
13	K 1852	Washer, 1" O.D., 17/32" I.D., 1/16" thick	377 to 416	1 oz.
14	0737 SR	P.T.O. bearing support bracket angle, right, 14-3/8" long Bolt, machine, 3/8 x 1" (4 used)	377 to 416	
15	0733 SR	Adjustment rod for drive chain, 1/2 x 6" long	377 to 416	1 oz.
16	K 1081	Cotter pin, 3/16" x 1" (2 used)	377 to 416	1 oz.
17	0734 SR	P.T.O. bearing support bracket, 28" long Bolt, machine, 3/8 x 1" (4 used)	377 to 416	6-1/4
18	K 2880	Washer, 1" O.D., x 7/16" I.D. x 1/16" thick (4 used)	377 to 416	1 oz.
19	0728 SR	P.T.O. bearing housing support plate, 3/16 x 7-1/2" x 10" Bolt, machine, 3/8 x 1" (4 used)	377 to 416	4-1/2
20	0735 SR	Bearing plate cross angle, 7/64 x 1-1/2" angle, 12-7/8" long	377 to 416	2
21	0736 SR	P.T.O. bearing support bracket angle, left, 25" long Bolt, machine, 3/8 x 1" (4 used)	377 to 416	4
22	K 1811	Nut, 5/8" fin. hex. (slotted)	377 to 416	1 oz.
23	K 847	Washer, 1-1/2" O.D. x 21/32" I.D. x 3/32" thick	377 to 416	1 oz.
24	K 900	Washer, 2" O.D. x 1-1/32" I.D. x 1/16" thick (2 used)	377 to 416	1 oz.
25	K 1858	Spacer, 1" O.D., 25/32" I.D., 5/16" thick	377 to 416	1 oz.
26	K 1817	Tapered roller bearing cone, 3/4" I.D.	377 to 416	1 oz.
27	K 1336	Pipe plug, 1/8 N.P.T.	377 to 416	1 oz.
28	K 1618	Tapered roller bearing cup, 2-1/2" O.D.	377 to 416	2 oz.
29	K 1856	Felt seal, 2-1/16" O.D., 1" I.D., 1/4" thick	377 to 416	1 oz.
30	K 1857	Felt seal, 2-1/2" O.D., 1-1/4" I.D., 1/4" thick	377 to 416	1 oz.
31	K 1071	Cotter pin, 1/8 x 3/4"	377 to 416	1 oz.
32	2590 P	Rivet for P.T.O. bearing shaft (drilled) 2-1/8 x 5/16"	377 to 416	1 oz.
33	K 3113	Bearing - bronze sintered (2 used)	377 to 416	1 oz.
34	K 3121	Clutch facing, 5-3/8" O.D., 3-1/2" I.D., 1/8" thick (2 used)	377 to 416	1/4
35	0763 SR	Clutch backup plate, 7-1/4" O.D., 3-1/2" I.D.	377 to 416	2-1/4
36	K 3189 A 1	Yoke, clutch plate and shaft assembly, Order K 3189 A-1	377 to 396	13
	K 3189 A 1	Yoke, clutch plate and shaft assembly	398 to 416	13

P.T.O. TELESCOPE DRIVE SHAFT ASSEMBLY

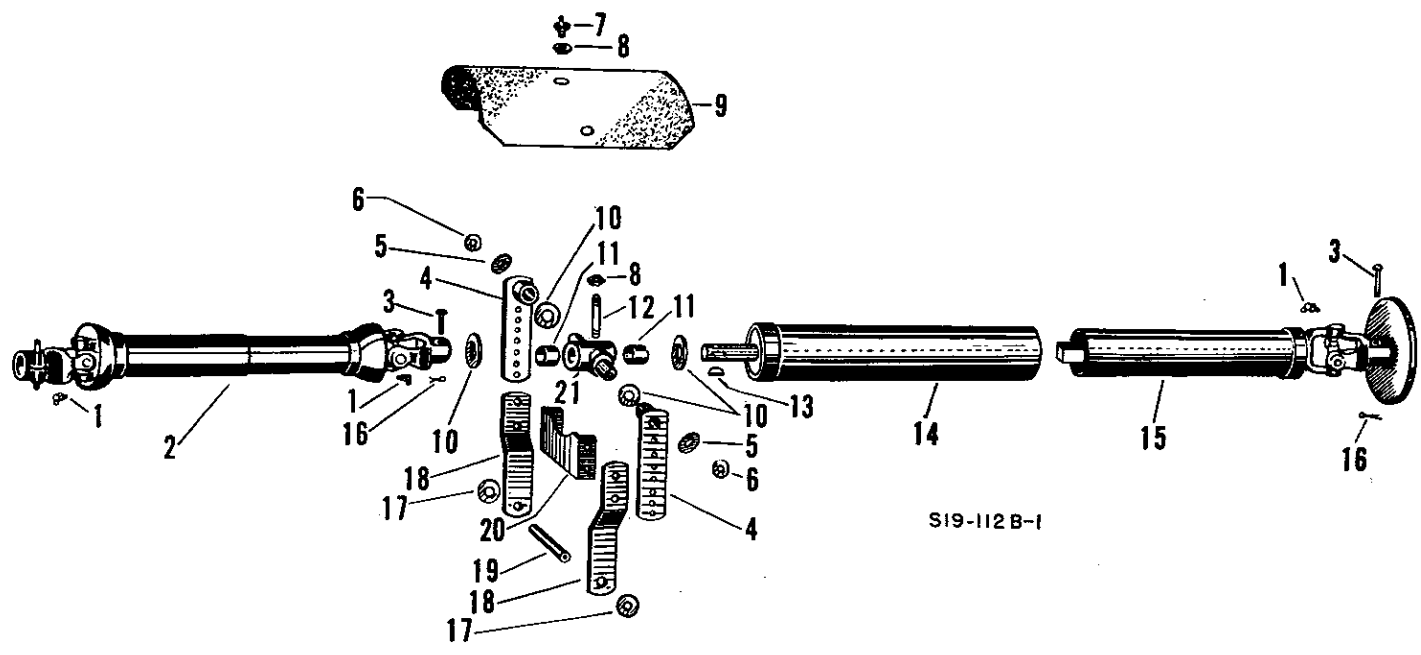

NO. 19 SPREADER

LOT 377 to 416

Ref.	Part No.	Description	Lot No.	Wt.Lbs.
1	K 624	Grease fitting, 1/8" pipe thread 90° - See K 623 and K 627.....	377 to 390	1 oz.
	K 623	Grease fitting, 1/8" pipe thread, 57-1/2 degree elbow		
		Replaces 2 - K 624 in K 2001 A for all lots.....	377 to 416	1 oz.
	K 627	Grease fitting, 5/16 - 32 N.S. threads, 67-1/2 degree elbow		
		Replaces K 624 in K 3189 A for all lots.....	377 to 416	
2	K 2001 A	Shield drive assembly (1-3/8" spline).....	377 to 416	15-1/2
3	2590 P	Pin, 5/16 x 2-1/4" oval head (drilled) (2 used).....	377 to 416	1 oz.
4	01413 BKA	Adjustable P.T.O. bearing support assembly (2 used).....	377 to 416	1-1/2
		Bolt, machine, 7/16 x 1-1/4" (2 used)		
5	K 3378	Washer, 1-3/4" O.D., 7/16" I.D., 1/8" thick (2 used).....	377 to 416	1 oz.
6	K 814 K 2880	Washer, 1" O.D., x 7/16" I.D., 1/16" thick (2 used), Order K 2880.	377 to 386	1 oz.
		Washer, 1" O.D., x 7/16" I.D., 1/16" thick, electro galvanized (2 used).....	390 to 416	1 oz.
7	K 626	Grease fitting, 1/4" N.S.T.	377 to 416	1 oz.
8	K 579	Jam nut, 1/2" hex. (2 used).....	377 to 416	1 oz.
9	0810 SR 0863 SR	Shield over swivel bearing, Order 0863 SR.....	377 only	1
		Shield over swivel bearing.....	386 to 416	1
		Bolt, machine, 3/8 x 3/4" (2 used)		
10	K 1780	Washer, 2" O.D., 1-9/32" I.D., 3/32" thick (3 used).....	377 to 416	1 oz.
11	K 1565	Bushing, steel backed bronze, 1-3/8" O.D., 1-1/2" I.D., 1-1/8" long (2 used).....	377 to 416	1/4
		Grease line, 1/2" O.D. x 2-7/8" long.....	377 to 416	2 oz.
12	K 3173	Key, #18 Woodruff, 1/4 x 1-1/8".....	377 to 416	1 oz.
13	K 590	Key, #18 Woodruff, 1/4 x 1-1/8".....	377 to 416	1 oz.
14	K 3188 A K 3188 A 1	Drive shaft tube assembly (1-1/4" rd. shaft), Order K 3188 A 1.....	377 to 396	9-3/4
		Drive shaft tube assembly (1-1/4" rd. shaft).....	398 to 416	
15	K 3189 A K 3189 A 1	Shaft, yoke, and clutch plate assembly (15/16" sq. shaft), Order K 3189 A 1.....	377 to 396	13
		Shaft, yoke, and clutch plate assembly (15/16" sq. shaft).....	398 to 416	
16	K 1071	Cotter pin, 1/8 x 3/4" (2 used).....	377 to 416	1 oz.
17	K 837 K 2881	Washer, 1-3/8" O.D., x 9/16" I.D., 1/16" thick (2 used), Order K 2881.....	377 to 386	1 oz.
		Washer, 1-3/8" O.D., x 9/16" I.D., 1/16" thick electro galvanized (2 used).....	390 to 416	1 oz.
18	0401 SR	P.T.O. front bearing support straps, 1/4 x 2-1/2" flat, 11-3/4" long (2 used).....	377 to 416	2
		Bolt, machine, 1/2 x 4-3/4"		
19	0708 SR	Spacer, for swivel bearing support, 3/4" O.D., 4-1/8" long.....	377 to 416	1 oz.
20	0709 SR	P.T.O. support channel, 5/32" thick.....	377 to 416	1
21	102 SRA	Front P.T.O. drive bearing assembly with 2 K 1565 bearings.....	377 to 416	3

ENDGATE ATTACHMENT

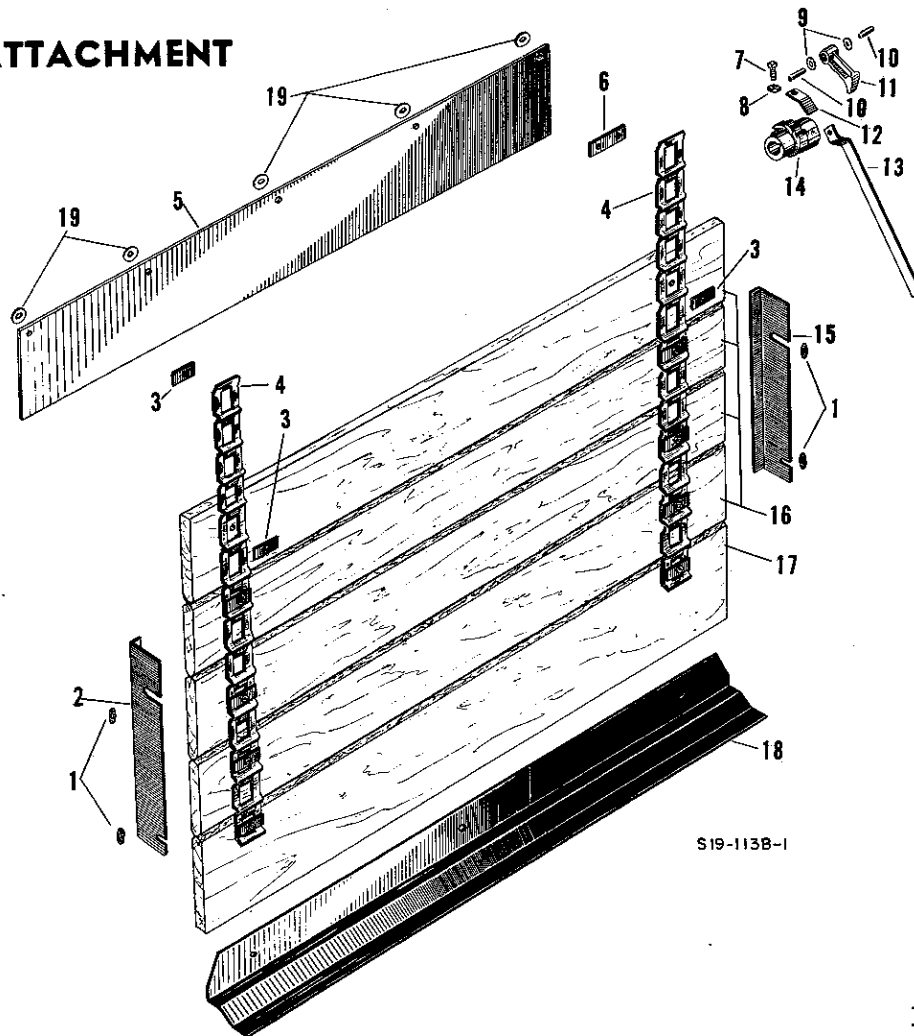

NO. 19 SPREADER

LOT 377 to 416

Ref.	Part No.	Description	Lot No.	Wt. Lbs.
1	K 2880	Washer, electro galv., 1" O.D., 7/16" I.D., 1/16" thick (4 used)	377 to 416	1 oz.
2	0859 SR	Endgate guide, left, 14 ga. x 3" flat, 16" long	377 to 416	1
		Bolt, carriage, 3/8 x 1-1/4" (2 used)		
3	0823 SR	Chain clip, 1/8 x 11/16" flat, 1-1/2" long (11 used)	377 to 416	1 oz.
		Bolt, machine, 3/8 x 1-1/4"		
4	52	Steel chain link (28 used)	377 to 416	1 oz.
5	0311 SR	Endgate retainer strip, 6" wide 43-1/2" long	377 to 416	1
		Machine screw, 5/16 x 3/4" (5 used)		
6	0822 SR	Tie strap, 1/8 x 1" flat, 2-3/4" long	377 to 416	1/4
		Bolt, machine, 3/8 x 1"		
		Bolt, machine, 3/8 x 1-1/4"		
7	K 1155	Set screw, 3/8" dia., 5/8" long regular head cup point. Order K-1165	377 to 386	1 oz.
	K 1165	Set screw, 3/8" dia., 1-1/4" long regular - head cup point	390 to 416	1 oz.
8	K 2884	Jam nut, 3/8" hexagon	390 to 416	1 oz.
9	K 837	Washer, 1-3/8" O.D., 9/16" I.D., 1/16" thick (2 used) Order K-2881	377 to 416	1 oz.
	K 2881	Washer electro galv., 1-3/8" O.D., 9/16" I.D., 1/16" thick (2 used)	390 to 416	1 oz.
10	1534 S	Bushing, 11/16" O.D., 1-1/16" long (2 used)	377 to 416	1 oz.
11	D 231	Retention pawl	377 to 416	1/2
12	0974 SR	Ratchet stop, 3/16 x 1-1/2" flat, 4-1/2" long	390 to 416	1/2
13	0827 SR	Ratchet lever, 5/16 x 1" flat, 18-1/2" long	377 to 416	1-3/4
14	105 SR	Ratchet hub 1" bore	377 to 416	4-1/2
15	0858 SR	Endgate guide, right, 14 ga. x 3" flat, 16" long	377 to 416	1
		Bolt, carriage, 3/8 x 1-1/4" (2 used)		
16	W 72 SR	Top and center boards, 25/32" x 3-7/16" x 44-3/8" long yellow pine (4 used)	377 to 416	3
		Bolt, carriage, 3/8 x 1-3/4" (2 used)		
17	W 71 SR	Bottom board, 25/32" x 6-15/16" x 44-3/8" long yellow pine	377 to 416	3
		Bolt, carriage, 3/8 x 1-3/4" (2 used)		
18	0464 SR	Main cylinder filler sheets, 6 x 39" long, 14 ga. (6 used)	377 to 416	5-1/2
19	K 3004	Washer, 13/16" O.D., 13/32" I.D., x 1/16" thick	377 to 416	1 oz.

P.T.O. SHIELDED DRIVE

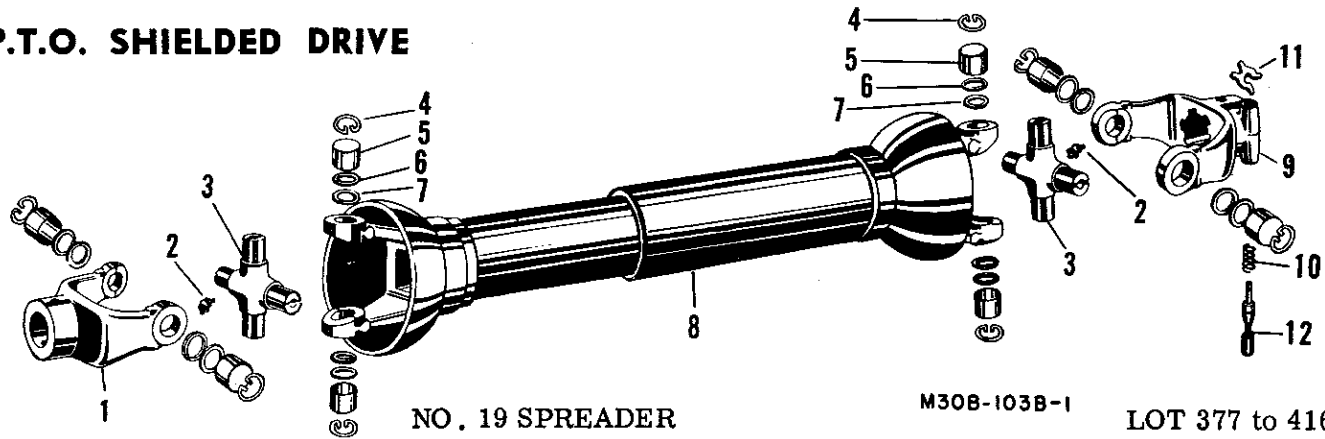

NO. 19 SPREADER

M30B-103B-1

LOT 377 to 416

Ref.	Part No.	Description	Lot No.	Wt. Lbs.
1	K 1896	Yoke, keywayed, 1-1/4" bore (Order K 4218)	377 to 403	2-1/2
	K 4218	Yoke, keywayed, 1-1/4" bore.....	408 to 416	2-1/2
2	K 623	Grease fitting, 1/8" pipe thread, 67-1/2 degree elbow	377 to 416	1 oz.
3	2929 P	Center cross (2 used)	377 to 416	1/4
	K 1911 A	Center cross kit complete	377 to 416	3/4
4	0652 HS	Snap ring (8 used)	377 to 416	1 oz.
5	2930 P	Bushing (8 used)	377 to 416	1 oz.
6	0654 HS	Cork washer (8 used)	377 to 416	1 oz.
7	2931 P	Cork retainer (8 used)	377 to 416	1 oz.
8	K 2001	Shielded drive and yokes	377 to 416	10-1/4
9	K 1830 A	Yoke, 1-3/8" spline	377 to 416	2-1/2
10	K 1846	Spring, compression, 7/8" long, 4 coils	377 to 416	1 oz.
11	K 3421	Spring clip	390 to 416	1 oz.
	K 1951	Cotter pin, 1/8 x 1/2" for quick lock pin	377 to 386	1 oz.
12	K 1847	Quick lock pin for yoke, 3-7/16" long Order K 3424	377 to 386	1/4
	K 3424	Quick lock pin for yoke	390 to 416	1/4

TELESCOPING SHAFT AND CLUTCH DISC

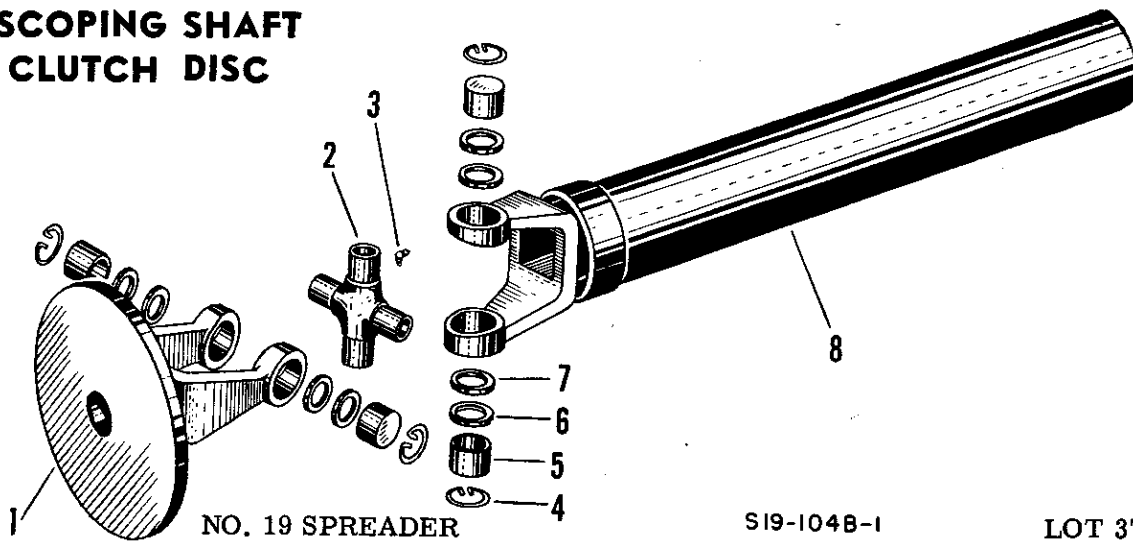

NO. 19 SPREADER

S19-104B-1

LOT 377 to 416

Ref.	Part No.	Description	Lot No.	Wt. Lbs.
1	0805 SRA	Clutch plate and yoke assembly, 5-3/4" O.D., 1-3/4" I.D.	377 to 416	3
2	2929 P	Center cross	377 to 416	1/4
	K 1911A	Center cross kit complete	377 to 416	3/4
3	K 623	Grease fitting, 1/8" pipe thread, 67-1/2 degree elbow	377 to 416	1 oz.
		Used with K 1911A only	377 to 416	1 oz.
4	0652 HS	Snap ring	377 to 416	1 oz.
5	2930 P	Bushing	377 to 416	1 oz.
6	0654 HS	Cork washer	377 to 416	1 oz.
7	2931 P	Cork retainer	377 to 416	1 oz.
8	K 3181A	Shaft and yoke assembly (5/16" sq. shaft).....	377 to 416	9-1/4

SPECIAL OUTBOARD FEED SHAFT BEARING ASSEMBLY KIT NO. 01105 SRA USED WITH S19-103B-1

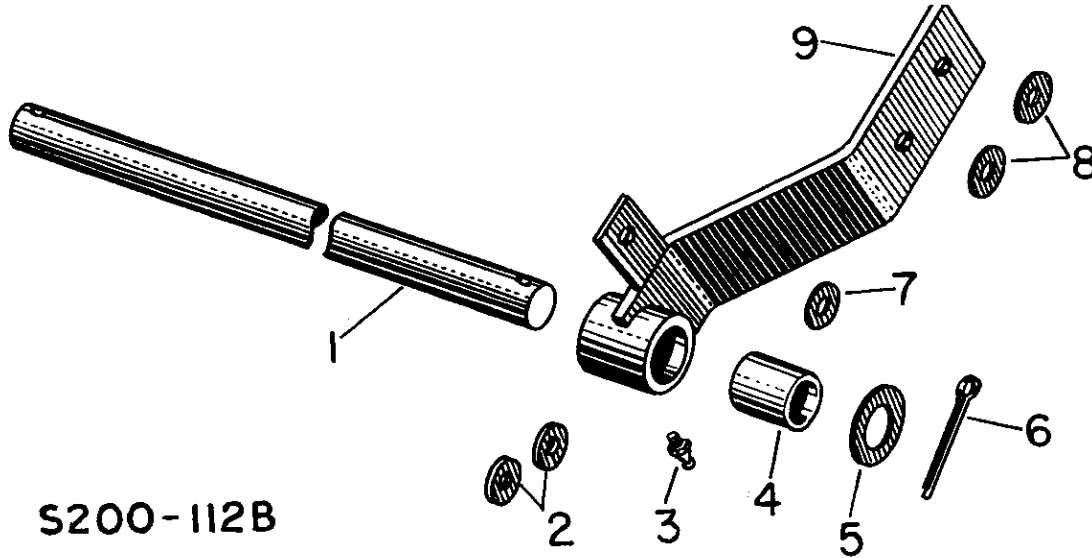

Ref.	Part No.	Description	Lot No.	Wt. Lbs.
1	0986 SR	Feed shaft, 1-3/16" Rd., 56-3/8" long	377 to 390	18
2	K 2248	Washer, 1-1/8" O.D., 17/32" I.D., 1/8" thick (used between shield and lower side angle) (2 used)	377 to 390	2 oz.
3	K 621	Grease fitting, 1/8" pipe thread straight	377 to 390	1 oz.
4	K 1842	Bearing, fiber, 1-7/16" O.D., 1-3/16" I.D., 1-1/2" long	377 to 390	1 oz.
5	K 886	Washer, 1-7/8" O.D., 1-7/32" I.D., 1/16" thick	377 to 390	1 oz.
6	K 1084	Cotter pin, 3/16 x 1-1/4"	377 to 390	1 oz.
7	K 3073	Washer, 1-3/8" O.D., 11/32" I.D., 1/16" thick galv.....	377 to 390	1 oz.
8	K 1852	Washer, 1" O.D., 17/32" I.D., 1/16" thick	377 to 390	1 oz.
9	01097 SRA	Outboard bearing with fiber bushing	377 to 390	4-1/4
		Bolt, machine, 1/2 x 1" (2 used)		

FORAGE BOX SIDES

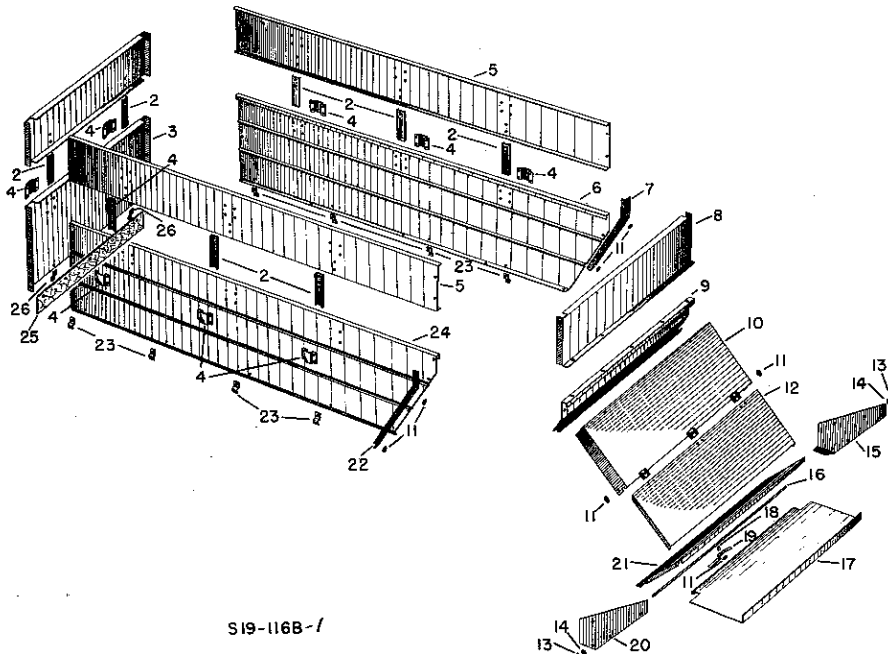

FORAGE BOX SIDES (CON'T)

Ref.	Part No.	Description	Lot No.	Wt.Lbs.
1	01138 SR	Front endgate upper section, 50-3/8" long..... Bolt, machine, 3/8 x 3/4" (8 used)	377 to 416	20
2	01136 SR	Channel stake, 2" wide, 13-5/8" long (8 used)..... Bolt, machine, 3/8 x 3/4" (2 used)	377 to 416	2
3	01120 SR	Front endgate lower section, 1/16 x 50-3/8" wide..... Bolt, machine, 3/8 x 3/4" (6 used)	377 to 416	26
4	01137 SR	Stake clamps (8 used)..... Bolt, machine, 3/8 x 3/4" (4 used)	377 to 416	11 oz.
5	01135 SR	Upper side sheet, 129-1/4" long (2 used).....	377 to 416	51
6	01119 SR	Lower side sheet right, 1/16 x 129-1/4" long.....	377 to 416	64
7	01145 SR	Rear upright angle, right..... Bolt, machine, 3/8 x 1"	377 to 416	3
8	01147 SR	Rear endgate, upper section, 51-1/2" long Bolt, machine, 3/8 x 3/4" (5 used)	377 to 416	21
9	01146 SR	Rear endgate lower section, 54-5/8" long.....	377 to 416	14
10	01122 SRA	Upper cylinder cover sheet with hinge..... Bolt, machine, 3/8 x 1" (2 used) Machine screw, 3/8 x 3/4" (2 used)	377 to 416	24
11	K 3004	Washer, 13/16" O.D., x 13/32" I.D., x 1/16" thick (12 used).....	377 to 416	1 oz.
12	01121 SR	Lower cylinder cover sheet..... Machine screw, 1/4 x 1/2" (6 used)	377 to 416	20
13	K 1073	Cotter pin, 1/8 x 1-1/4" long (2 used).....	377 to 416	1 oz.
14	K 2881	Washer, 1-3/8" O.D., x 9/16" I.D., x 1/16" thick (2 used).....	377 to 416	1 oz.
15	01126 SR	Bracket for tray, right..... Bolt, machine, 5/16 x 1-3/4" (2 used)	377 to 416	2
16	01125 SR	Rod for tray, 1/2" I.D. x 48-1/4" long.....	377 to 416	3
17	01124 SR	Tray sheet, 45-1/2" long.....	377 to 416	20
18	K 3620	Spacer, 1/2" O.D., x 25/64" I.D., x 1/4" long.....	377 to 416	1 oz.
19	01131 SR	Tray lock lever..... Bolt, machine, 3/8 x 1"	377 to 416	9 oz.
20	01127 SR	Bracket for tray, left..... Bolt, machine, 5/16 x 1-3/4" (2 used)	377 to 416	2
21	01123 SR	Rear enclosure sheet..... Machine screw, 1/4 x 1/2" (2 used)	377 to 416	25
22	01144 SR	Rear up right angle, left..... Bolt, machine, 3/8 x 3/4" (2 used) Bolt, machine, 3/8 x 3/4" (2 used)	377 to 416	3
23	01129 SR	Side clamp (8 used)..... Bolt, machine, 3/8 x 3/4" (4 used)	377 to 416	7 oz.
24	01118 SR	Lower side sheet, left, 1/16 x 129-1/4" long.....	377 to 416	68
25	0311 SR	Endgate retainer strip belting, 6 x 43-1/2" long..... Machine screw, 5/16 x 1" (5 used)	377 to 416	1
26	01130 SR	Front clamp (2 used)..... Bolt, machine, 3/8 x 3/4"	377 to 416	8 oz.