

## NO. 18 SPREADER

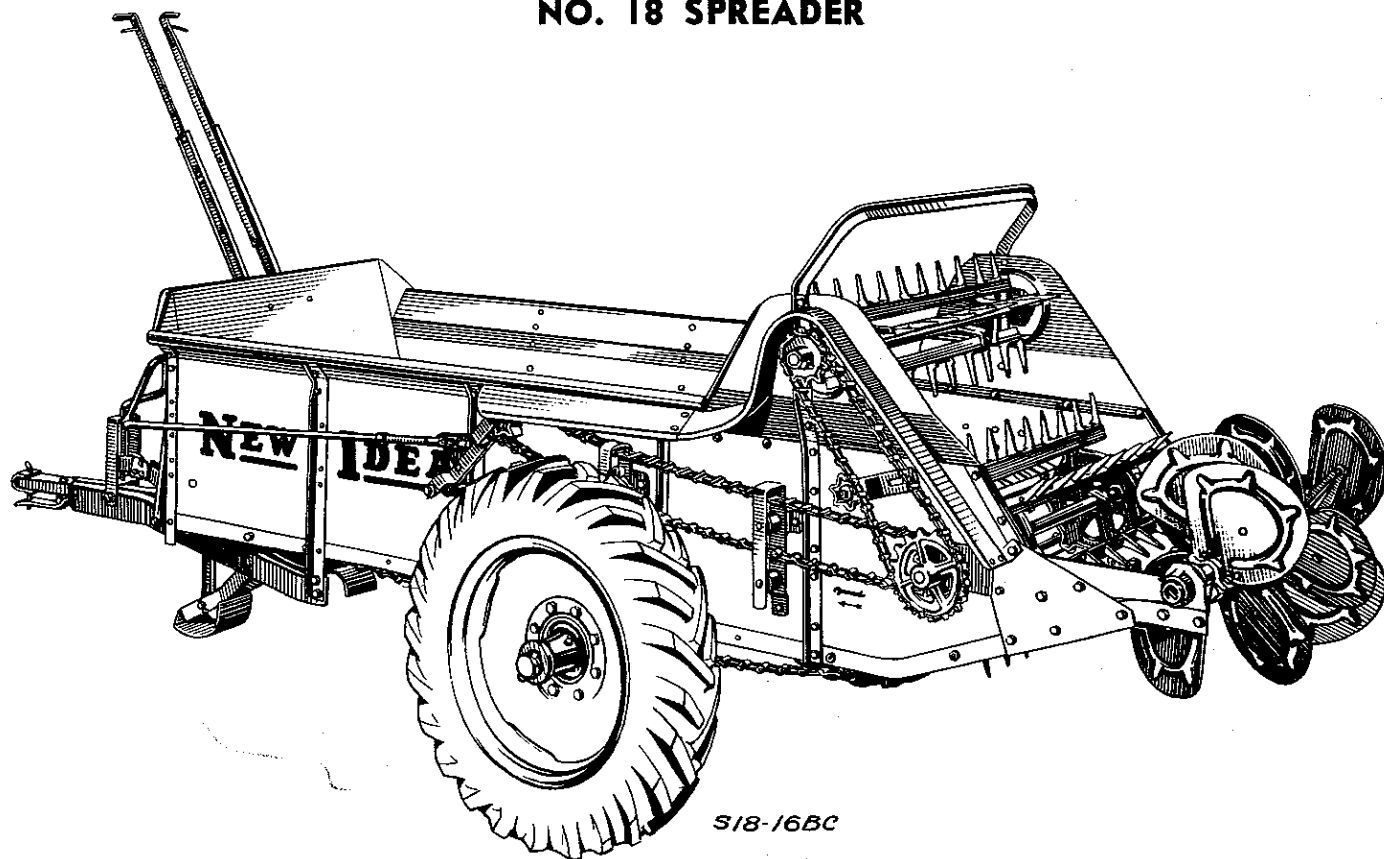

Year Built 1955 to \_\_\_\_\_

Lots 375 to ---

### INDEX OF NO. 18 SPREADER

Axle and wheels	39
Bottom	37
Distributor	43
Endgate Attachment	48
Endgate and Levers	38
Feed Mechanism	45
Feed shaft and conveyor	44
Hitch	40
Main cylinder	41
Main Drive	46, 47
Sides and arch	36
Special levers, Ford and Ferguson Tractors	47
Upper cylinder	42

# SIDES AND ARCH

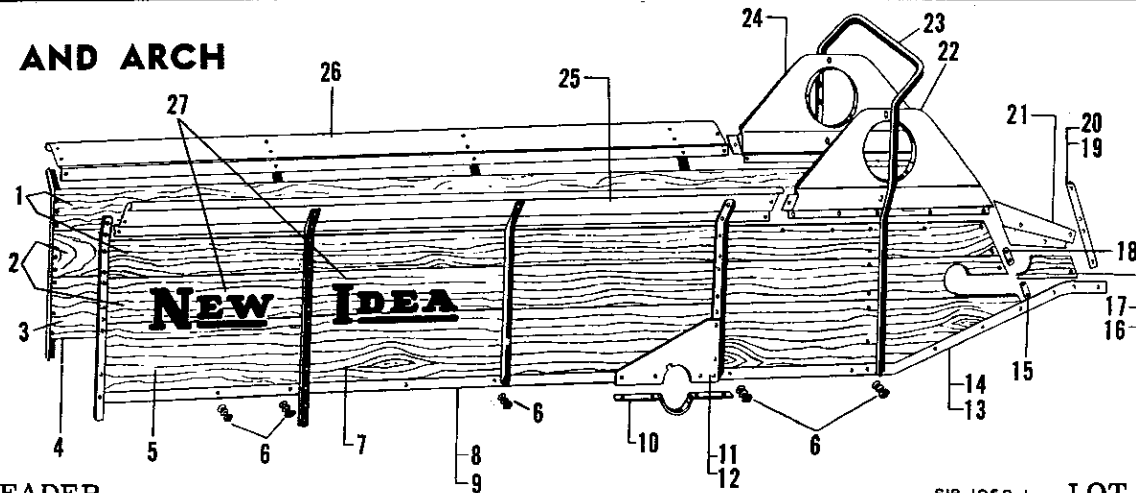

NO. 18 SPREADER

S18-105B-1 LOT 375 to

Ref.	Part No.	Description	Lot No.	Wt. Lbs.
1	W 128	Top board for left and right side .....	375 to ---	11
2	W 127	Center board for left and right side .....	375 to ---	12
3	W 130	Lower side board, right side.....	375 to ---	14
4	W 130 A 1	Side complete, right.....	375 to ---	77 lbs.
5	W 126	Lower side board, left side.....	375 to ---	14
6	K 2940	Bolt for attaching sides to bottom, 1/2" dia., 1-1/8" long, special carriage (10 used).....	375 to ---	2 oz.
7	W 126 A 1	Side complete, left.....	375 to ---	76 lbs.
8	1388 S	Front main side angle, right, 1-3/4 x 1-1/4 x 3/16" angle, 66-3/4" long .....	375 to ---	9-3/4
9	1389 S 1	Front main side angle, left, 1-3/4 x 1-1/4 x 3/16" angle, 66-3/4" long .....	375 to ---	9-3/4
10	1397 S	Axle bearing clamp, 5/16 x 1-1/4" flat 20-3/4" long .....	375 to ---	2-1/4
		Bolt, machine, 3/8 x 1" (3 used)		
		Bolt, machine, 3/8 x 1-1/2" long, with 2 hexagon nuts		
11	1379 S	Axle plate, right.....	375 to ---	6
12	1380 S	Axle plate, left.....	375 to ---	6
13	1382 S	Rear main side angle, left, 1-3/4 x 1-1/4 x 3/16" angle, 60-5/8" long .....	375 to ---	9-1/4
		Rivet, oval head, 3/8 x 7/8"		
		Rivet, oval head, 3/8 x 1"		
14	1381 S	Rear main side angle, right, 1-3/4 x 1-1/4 x 3/16" angle, 60-5/8" long .....	375 to ---	9-1/4
		Rivet, oval head, 3/8 x 7/8"		
		Rivet, oval head, 3/8 x 1"		
15	1144 S	Reinforcing plate at rear end of sides, 1-1/16" x 4" long, 14 gauge (lower 2 used).....	375 to ---	1/4
16	W 133	Filler piece for rear end of side, right.....	375 to ---	1/4
17	W 129	Filler piece for rear end of side, left.....	375 to ---	1/4
18	1731 S	Reinforcing plate at rear end of sides, 1-1/16" x 4" long, 14 gauge (upper 2 used).....	375 to ---	2 oz.
19	1748 S	Rear end angle on side, left, 1-3/8 x 1 x 5/32" angle, 14-5/8" long. Bolt, carriage, 5/16 x 1-1/2" Bolt, carriage, 3/8 x 1-3/4" (2 used)	375 to ---	1-1/2
20	1747 S	Rear end angle on side, right, 1-3/8 x 1 x 5/32" angle 14-5/8" long Bolt, carriage, 5/16 x 1-1/2" Bolt, carriage, 3/8 x 1-1/2" (2 used)	375 to ---	1-1/2
21	1317 S	Filler shield for left side angle, Order 0831-SR.....	375 only	1/4
		Bolt, machine, 5/16 x 3/4" (2 used)		
		Bolt, machine, 5/16 x 1"		
	0831 SR	Filler shield for left side.....	381 to ---	1
		Bolt, machine, 5/16 x 3/4"		
		Bolt, machine, 5/16 x 1"		
22	0618 SR	Upper cylinder shield, left (Order 0618 SRA) .....	375 to 413	
	0618 SRA	Upper cylinder shield, left .....	420 to ---	
	K 3801	Lamp bracket.....	375 to ---	
		Bolt, carriage, 5/16 x 1-1/4" zinc plated (4 used)		
		Machine screw, 5/16 x 7/8" (2 used)		
		Machine screw, 5/16 x 3/4"		

Ref.	Part No.	Description	Lot No.	Wt.Lbs.
23	0615 SR	Arch, 1-3/8 x 1-3/16" angle, 125-3/4" long..... Bolt, carriage, 5/16 x 1-1/4" zinc plated (10 used) Bolt, carriage, 5/16 x 1-1/2" zinc plated (2 used) Bolt, machine, 5/16 x 1" (2 used)	375 to ---	14-3/4
24	0617 SR	Upper cylinder shield, right..... Bolt, carriage, 5/16 x 7/8" (2 used) Machine screw, 5/16 x 3/4"	375 to ---	5-1/2
25	0613 SR	Flare board, left, Order 0613 SR-1.....	375 to 413	21-1/4
	0613 SR-1	Flare board, left.....	420 to ---	21-1/4
26	0614 SR	Flare board, right, Order 0614 SR-1.....	375 to 413	21-1/2
	0614 SR-1	Flare board, right.....	420 to ---	21-1/2
27	K 1923	New Idea 5" stencil, Order K 4865.....	375 to 413	1 oz.
	K 4865	New Idea stencil.....	420 to ---	1 oz.
28	K 3801	Lamp bracket.....	375 to ---	

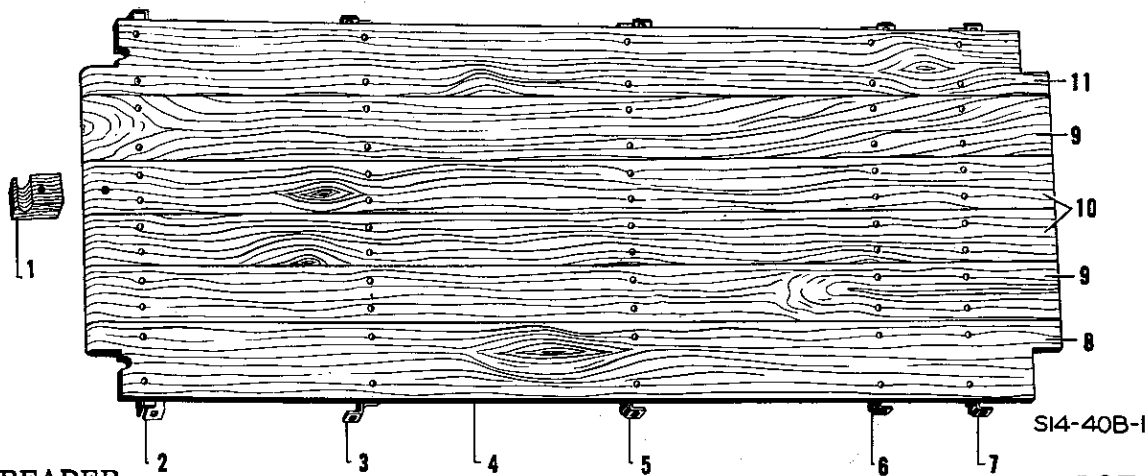

NO. 18 SPREADER

LOT 375 to

Ref.	Part No.	Description	Lot No.	Wt.Lbs.
1	W 171	Center feed shaft bearing, 1-7/8 x 2-7/8 x 3-3/8" long, Order 200643.....	375 to 418	1
	200643	Center feed shaft bearing.....	420 to ---	1
2	1087 SA	Rear cross angle with end brackets, 1-3/4 x 1-1/4 x 3/16", angle 38-1/2".....	375 to 413	6
	01439 SRA	Rear cross angle with end brackets, 1-3/4 x 1-1/4 x 3/16", angle 38-13/16".....	420 to ---	6
3	1086 SA	Fourth from front cross angle with end brackets 1-3/4 x 1-1/4 x 3/16" angle, 37-9/16" long, Order 01438 SRA.....	375 to 413	6
	01438 SRA	Fourth from front cross angle with end brackets 1-3/4 x 1-1/4 x 3/16" angle, 37-9/16" long.....	420 to ---	6
4	W 158 A	Bottom, complete, Order 111 SRA.....	375 to 413	114
	W 111 SRA	Bottom, complete.....	420 to ---	114
5	1085 SA	Third from front cross angle with end brackets, 1-3/4 x 1-1/4 x 3/16" angle, 37-3/16" long, Order 01437 SRA.....	375 to 413	6
	01437 SRA	Third from front cross angle with end brackets, 1-3/4 x 1-1/4 x 3/16" angle, 37-3/16" long.....	420 to ---	6
6	1084 SA	Second from front cross angle with end brackets, 1-3/4 x 1-1/4 x 3/16" angle, 36-13/16" long, Order 01436 SRA.....	375 to 413	6
	01436 SRA	Second from front cross angle with end brackets, 1-3/4 x 1-1/4 x 3/16" angle, 36-13/16" long.....	420 to ---	6
7	1396 SA	Front cross angle with end brackets, 1-1/2 x 1-1/4 x 5/32" angle, 36-3/4" long, Order 01435 SRA.....	375 to 413	5-3/4
	01435 SRA	Front cross angle with end brackets, 1-1/2 x 1-1/4 x 5/32" angle, 36-3/4" long.....	420 to ---	5-3/4
8	W 162	Right outside bottom board.....	375 to 413	12
	W 113 SR	Right outside bottom board.....	420 to ---	12
9	W 159	Second from left and second right bottom board (2 used)..... Rivet, W. B. head, 1/4 x 1-3/16" (10 used)	375 to ---	7
10	W 160	Center bottom boards (2 used).....	375 to 413	11
	W 114 SR	Center bottom boards.....	420 to ---	11
11	W 163	Left outside bottom board.....	375 to 413	12
	W 112 SR	Left outside bottom board.....	420 to ---	12
		Rivet, W. B. head, 1/4 x 1-3/16" (10 used)		
12	K 2879	Washer, 7/8" O.D. x 3/8" I.D. x 3/64" thick.....	375 to ---	1 oz.

ENDGATE AND LEVERS

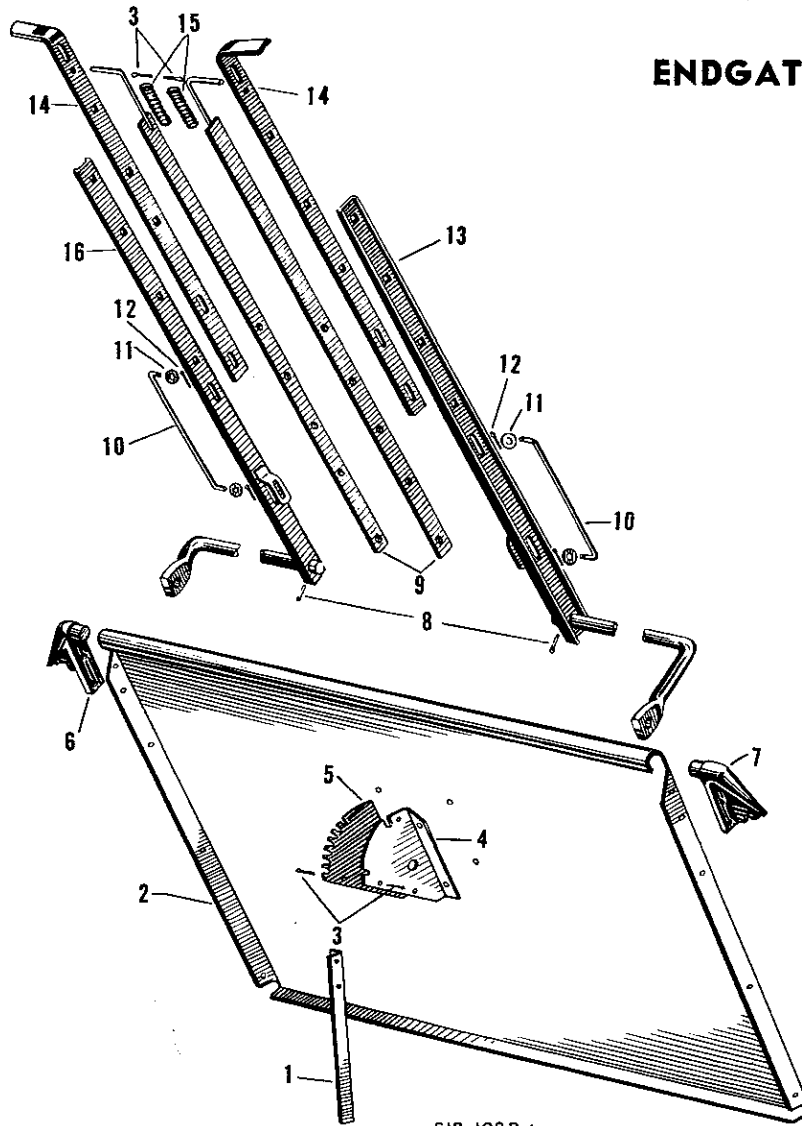

S18-102 B-1

NO. 18 SPREADER

LOT 375 to

Ref.	Part No.	Description	Lot No.	Wt. Lbs.
1	1403 S	Endgate brace angle, 1-1/4 x 1-1/2 x 5/32" angle, 20-5/16" long, Order 01501 SR.....	375 to 413	2-1/4
	01501 SR	Endgate brace angle, 1-1/4 x 1-1/2 x 5/32" angle, 20-5/16" long.....	420 to ---	2-1/4
2	0619 SR	Front endgate .....	375 to 413	40
	01499 SR	Front endgate .....	420 to ---	40
3	K 1090	Cotter pin, 1/4" dia., 3/4" long with 11/32" hole in eye.....	375 to ---	2 oz.
4	0644 SR	Drive sector.....	375 to ---	4
5	0645 SR	Feed sector.....	375 to ---	4
6	62 SR	Front endgate, corner casting, right, Order 62 SR 1.....	375 to 413	3
	62 SR 1	Front endgate, corner casting, right.....	420 to ---	3
7	61 SR	Front endgate, corner casting, left, Order 61 SR 1.....	375 to 413	3
	61 SR 1	Front endgate, corner casting, left.....	420 to ---	3
8	K 1083	Cotter pin, 3/16" dia., 1-1/2" long .....	375 to ---	1 oz.
9	1033 SA	Main lever rod with handle.....	375 to ---	1
10	1735 S	Main lever latch.....	375 to ---	1/4
11	K 814	Washer, 1" O.D., 7/16" I.D., 16 gauge, Order K-2880 .....	375 to 385	1 oz.
	K 2880	Washer, 1" O.D., 7/16" I.D., 16 gauge, electro galvanized.....	391 to ---	1 oz.
12	K 1071	Cotter pin, 1/8" dia., 3/4" long.....	375 to 111	1 oz.
13	0528 SRA	Drive lever assembly.....	375 to ---	15
14	1629 S	Feed and drive levers, 1/4 x 1-1/2" flat, 27-1/8" long.....	375 to ---	2-1/2
		Bolt, carriage, 3/8 x 7/8" (2 used)		
15	1509 S	Compression spring, 5/8" O.D., 2-1/2" long 13 coils.....	375 to ---	2 oz.
16	1734 SA	Feed rod control shaft with lever base, 1" Rd., 25-57/64" long.....	375 to ---	11

## AXLE AND WHEELS

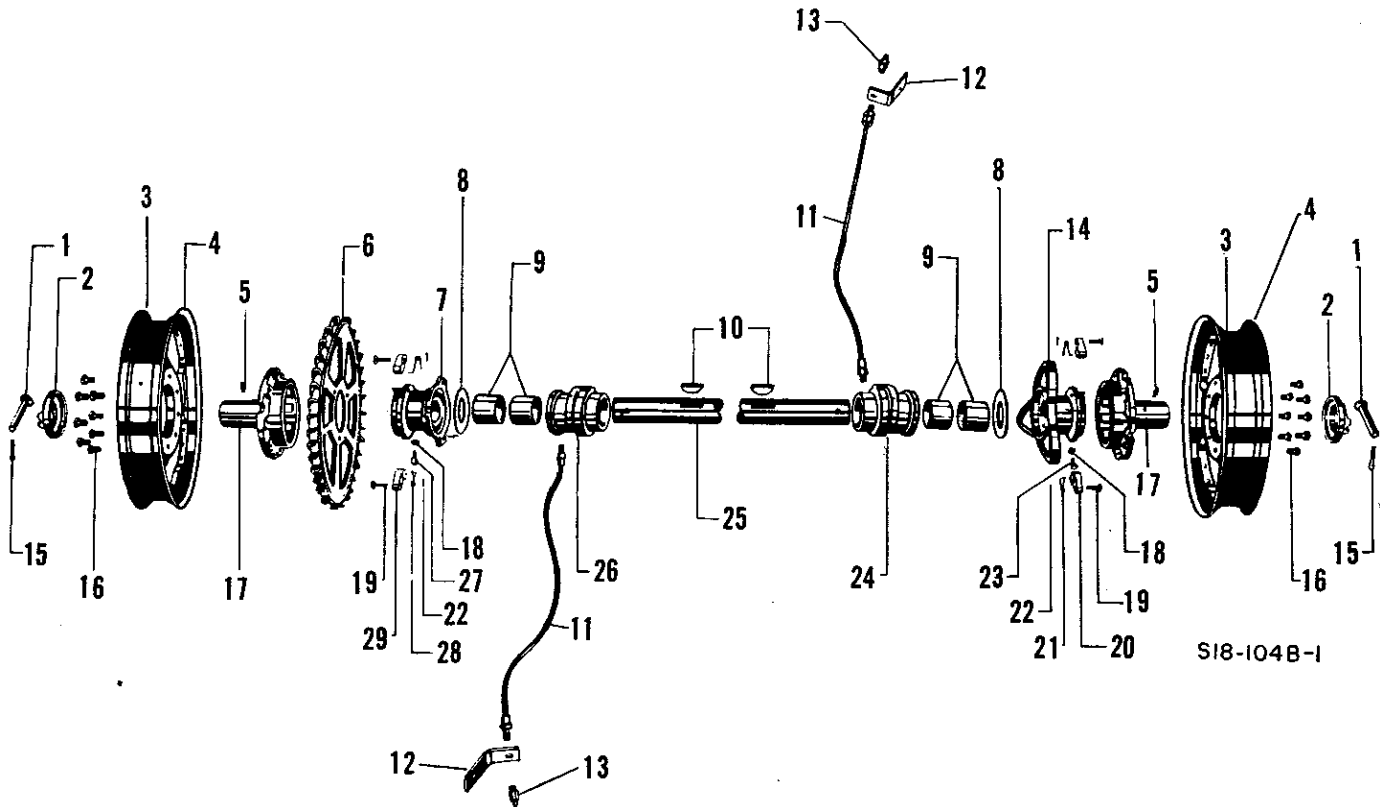

NO. 18 SPREADER

LOT 375 to

Ref.	Part No.	Description	Lot No.	Wt.Lbs.
1	980 S	Axle pin, 1/2" dia., 3-1/4" long, oval head .....	375 to ---	1/4
2	L 488	Axle collar .....	375 to ---	1-1/4
3	K 1214	Flange ring used with K-1213, 20" disc wheel .....	375 to 385	4-3/4
	K 2599	Flange ring used with K-2598, 20" disc wheel .....	375 to 381	4-3/4
4	K 1213	Disc wheel, 20" with flange ring. ....	375 to 381	60
	K 2598 A	Disc wheel with flange ring, 20" .....	375 to 381	42
	K 2599	Ring for K 2598 wheel .....	375 to 381	
	K 3374	Drop center rim, 20" .....	385 to ---	34-1/2
5	K 622	Grease fitting, 1/8" pipe thread, 30-Degree elbow .....	375 to ---	1 oz.
6	L 519	32-tooth sprocket wheel Order 122 SR .....	375 to 391	23-1/2
	122 SR	32 tooth main drive sprocket .....	395 to ---	23-1/2
7	L 518 A	Sprocket wheel hub with pawls and springs, 2" bore. Uses K-598 key .....	375 to ---	18-1/2
8	K 1649	Washer, 4-1/4" O.D., 2-1/2" I.D., 7/64" thick .....	375 to ---	1/4
9	K 1549	Bronze steel backed bushing, 2" I.D., 2" long .....	375 to ---	1/4
10	K 598	No. 29 Woodruff key, 3/8" thick, 2-5/16" long .....	375 to ---	2 oz.
11	K 2919	Axle bearing grease line (2 used) .....	375 to ---	3 oz.
12	0616 SR	Lubrication bracket, 3/16 x 1-1/4" flat, 3-3/8" .....	375 to ---	1/4
13	K 625	Grease fitting, 1/8" female pipe thread, straight .....	375 to ---	1 oz.
14	L 521 A	Feed cam with pawls and spring, 2" bore. Uses K-598 key .....	375 to ---	22-1/2
15	K 1081	Cotter pin, 3/16" dia., 1" long .....	375 to ---	1 oz.
16	1078 S	Hub bolt, 9/16" dia., 1-1/2" long .....	375 to ---	2 oz.
17	L 496	Wheel hub, 2" bore .....	375 to ---	34
18	K 744	Lock nut, 1/2" .....	375 to ---	1 oz.
19	1505 S	Pin for pawls, 1/4" dia., 1-7/8" long, W.B. head (Order 013240) .....	375 to ---	1 oz.
	013240	Pin for pawls .....	---	---
20	18 C	Pawl for feed cam .....	375 to ---	1/4
21	1515 S	Torsion spring for feed cam .....	375 to ---	1 oz.
22	K 1066	Cotter pin, 3/32" dia., 1/2" long .....	375 to ---	1 oz.
23	K 1191	Set screw, 1/2" dia., 1-1/2" long .....	375 to ---	1 oz.
24	L 566 A	Axle bearing housing with 2 K-1549 bushings, right .....	375 to ---	8
25	1395 S	Axle, 2" rd., 70-5/8" long .....	375 to ---	63
	1395 SA	Axle complete with 1 L-518A, 1 L-521A, 1 L-565A, and 1 L-566A .....	375 to ---	104
26	L 565 A	Axle bearing housing with 2 K-1549 bushing, left .....	375 to ---	8
27	K 1189	Set screw, 1/2" dia., 1-1/4" long .....	375 to ---	1 oz.
28	1516 S	Torsion spring for sprocket wheel hub .....	375 to ---	1 oz.
29	17 C	Pawl for sprocket hub .....	375 to ---	1/4

## HITCH

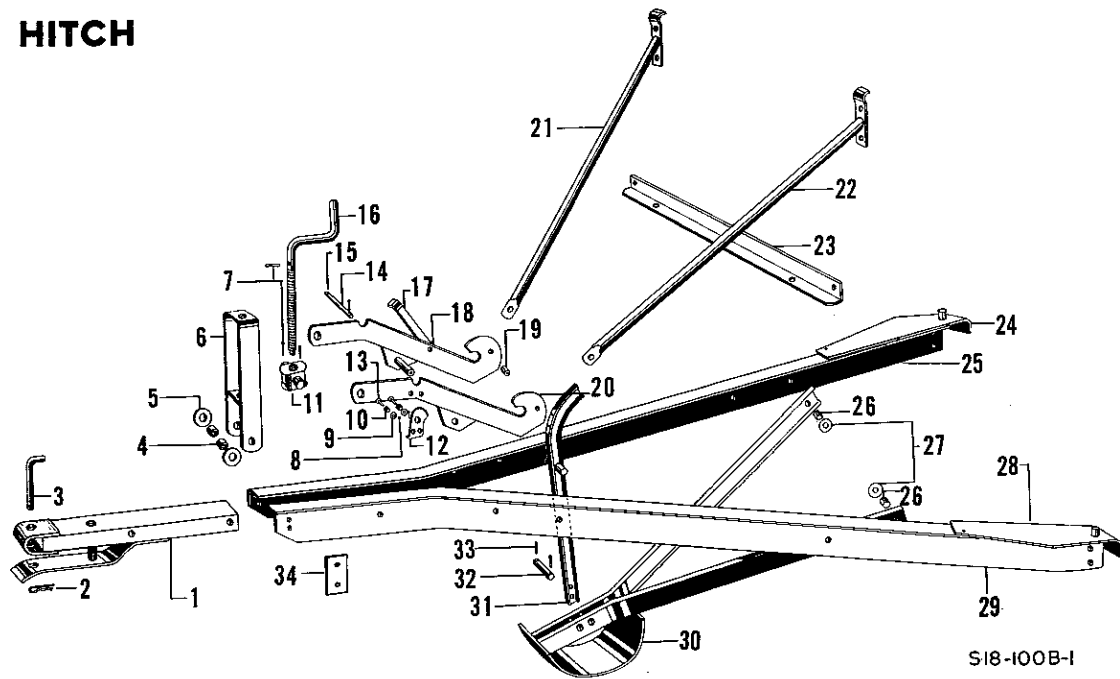

S18-100B-1

## NO. 18 SPREADER

LOT 375 to

Ref.	Part No.	Description	Lot No.	Wt. Lbs.
1	0186 SRA	Hitch tube assembly, Order 0186 SRA 1	375 to 413	9
	0186 SRA 1	Hitch tube assembly	420 to ---	9
2	2629 P	Spring clip	375 to ---	2 oz.
3	550 P 1	Pin for hitch connection, 3/4" rd., 7-3/16" long	375 to ---	3/4
4	1302 S	Bushing, 7/8" O.D., 3/8" long	375 to ---	1 oz.
5	K 847	Washer, 1-1/2" O.D., 21/32" I.D., 3/32" thick	375 to ---	1 oz.
6	995 SA	Guide for adjusting crank, 5/16 x 2" flat, 26-1/4" long	375 to ---	5-1/4
		Bolt, machine, 5/8 x 5-1/4"		
7	K 1094	Cotter pin, 1/4" dia., 1-1/2" long (3 used)	375 to ---	1 oz.
8	K 1066	Cotter pin, 3/32" dia., 1/2" long (2 used)	375 to ---	1 oz.
9	K 807	Washer, 3/4" O.D., 5/16" I.D., 3/64" thick, Order K-2878	375 to 413	1 oz.
	K 2878	Washer, 3/4" O.D., 5/16" I.D., 3/64" thick, electro galvanized	420 to ---	1 oz.
10	1307 S	Compression spring, 1/2" O.D., 15/16" long, 5 coils	375 to ---	1 oz.
11	L 487	Nut for adjusting crank	375 to ---	1/4
12	1305 S	Latch for sliding arm	375 to ---	1/4
13	1306 S	Pin for sliding arm latch, 1/4" dia., 1-1/4" long	375 to ---	1 oz.
14	1003 S	Rod for adjusting arms, 1/2" rd., 8-1/4" long	375 to ---	1/2
15	K 1081	Spring cotter, 3/16" dia., 1" long (2 used)	375 to ---	1 oz.
16	994 S	Adjusting crank, 7/8" rd., 19-3/16" long	375 to ---	3-1/4
17	999 S	Lock on adjusting arm, 3/16 x 1" flat, 10-1/2" long	375 to ---	1/2
18	997 SA	Adjusting arm, right, Order 01428 SRA	375 to 413	4-1/2
	01428 SRA	Adjusting arm, right	420 to ---	4-1/2
19	1001 S	Spacer, 3/8" I.D., 7/8" long	375 to ---	4-1/2
		Bolt, machine, 3/8 x 2"	375 to ---	1 oz.
20	1334 SA	Adjusting arm, left, Order 01427 SRA	375 to 413	4-1/2
	01427 SRA	Adjusting arm, left	420 to ---	4-1/2
21	1419 SA	Hitch brace, right	375 to ---	3-3/4
		Bolt, machine, 3/8 x 1" with lockwasher (2 used)		
22	1420 SA	Hitch brace, left	375 to ---	3-3/4
		Bolt, machine, 3/8 x 1" (2 used)		
23	1404 S	Front cross sill, 2-1/2 x 1-1/2 x 3/16" angle, 38" long	375 to ---	7-3/4
		Bolt, machine, 1/2 x 1" (2 used)		
24	A 941 S 1	Conveyor chain slide with guide, right, 1/8 x 4-1/2" flat, 17" long	375 to ---	2-3/4
25	1530 SA 1	Hitch iron with conveyor slide, right, 70-3/8" long	375 to ---	20
		Bolt, machine, 7/16 x 1" (2 used)		
		Bolt, machine, 1/2 x 1" (3 used)		
26	1009 S	Bushing, 3/4" O.D., 5/8" long	375 to ---	1 oz.
27	K 837	Washer, 1-3/8" O.D., 9/16" I.D., 1/16" thick, Order K-2881	375 to 413	1 oz.
	K 2881	Washer, 1-3/8" O.D., 9/16" I.D., 1/16" thick, electro galvanized	420 to ---	1 oz.
28	A 942 S 1	Conveyor chain slide with guide, left, 1/8 x 4-1/2" flat, 17" long	375 to ---	2-3/4
29	1531 SA 1	Hitch iron with conveyor slide, left, 70-3/8" long	375 to ---	20
		Bolt, machine, 7/16 x 1" (2 used)		
		Bolt, machine, 1/2 x 1" (3 used)		
30	1008 SA	Shoe with brace bars	375 to ---	14-1/2
		Bolt, machine, 1/2 x 1-1/2" (2 used)		
31	1004 SA	Sliding arm, 1-1/2 x 21/32" T <sub>h</sub> bar, 21-1/4" long	375 to ---	2-1/2
32	1006 S	Pin in shoe assembly, 3/4" rd., 2-1/2" long	375 to ---	1/4
33	K 1082	Cotter pin, 3/16" dia., 1-1/4" long (2 used)	375 to ---	1 oz.
34	1528 S	Shim for hitch irons (2 used)	375 to ---	1/4

MAIN CYLINDER

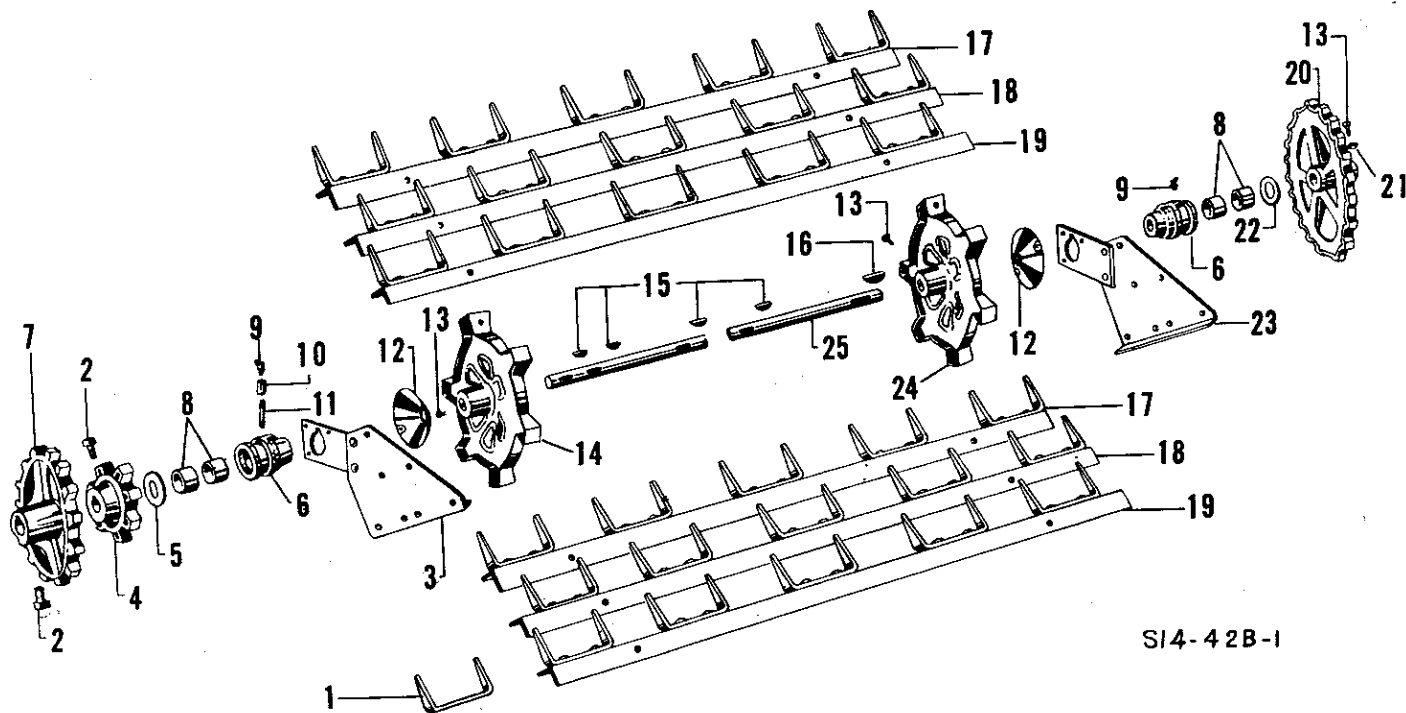

SI4-42B-1

NO. 18 SPREADER

LOT 375 to

Ref.	Part No.	Description	Lot No.	Wt. Lbs.
1	1527 S	Cylinder bar tooth .....	375 to ---	1/2
		Rivet, oval head, 5/16 x 3/4" (2 used)		
2	K 1942	Set screw, 1/2 x 7/8 low head cup point (2 used) .....	375 to ---	1 oz.
3	1310 SA	Bearing plate complete, left .....	375 to ---	7-1/2
		Bolt, machine, 3/8 x 7/8"		
		Bolt, carriage, 3/8 x 1-1/4" (2 used)		
		Bolt, carriage, 3/8 x 1-1/2" (2 used)		
		Bolt, carriage, 3/8 x 1-3/4"		
4	L 484	7-tooth drive sprocket, 1-1/16" bore, Uses K-598 key .....	375 to ---	3-1/4
5	1498 S	Bearing closure washer, 2" O.D., 1-3/32" I.D., 1/8" thick .....	375 to ---	2 oz.
6	L 557 A	Cylinder bearing assembly with 2 K-1529 bushings .....	375 to ---	1-1/2
7	L 485	15-tooth sprocket to drive upper cylinder, 1-1/16" bore. Uses K-589 key ...	375 to ---	5
8	K 1529	Bronze steel backed bushing, 1-1/16" I.D., 1-1/4" long .....	375 to ---	3 oz.
9	K 623	Grease fitting, 1/8" pipe thread, 67-1/2 degree elbow .....	375 to ---	1 oz.
10	K 655	Pipe coupling, 1/8" .....	375 to ---	1 oz.
11	K 639	Pipe nipple, 1/8" I.D., 2" long .....	375 to ---	1 oz.
12	1161 S	Anti-wrap shields, 6" dia. ....	375 to ---	3/4
		Bolt, carriage, 1/4 x 1-1/2" (2 used)		
13	K 1185	Set screw, 1/2" dia., 1" long .....	375 to ---	1 oz.
14	L 573	Cylinder head, 1-1/16" bore. Uses K-589 key left .....	375 to ---	11-1/4
15	K 589	No. 13 Woodruff key, 3/16" thick, 1" long .....	375 to ---	1 oz.
16	K 587	No. 26 Woodruff key, 3/16" thick, 1-3/4" long .....	375 to ---	1 oz.
17	1549 SA	Cylinder bar with teeth, 1-3/8 x 1-3/8 x 5/32" long (2 used) .....	375 to ---	6-3/4
		Bolt, machine, 3/8 x 1" (2 used)		
18	1548 SA	Cylinder bar with teeth, 1-3/8 x 1-3/8 x 5/32" angle, 36-3/8" long (2 used) .	375 to ---	6-3/4
		Bolt, machine, 3/8 x 1" (2 used)		
19	1550 SA	Cylinder bar with teeth, 1-3/8 x 1-3/8 x 5/32" angle, 36-3/8" long (2 used) .	375 to ---	6-3/4
		Bolt, machine, 3/8 x 1" (2 used)		
20	L 482	20-tooth sprocket to drive distributor, 1-1/6" bore. Uses K-587 key .....	375 to ---	7-3/4
21	K 579	Jam nut, 1/2" hexagon .....	375 to ---	1 oz.
22	1015 S	Bearing closure washer, 2" O.D., 1-3/32" I.D., 3/64" thick .....	375 to ---	1 oz.
23	1309 SA	Bearing plate, complete, right .....	375 to ---	7-1/2
		Bolt, machine, 3/8 x 7/8"		
		Bolt, carriage, 3/8 x 1-1/4" (3 used)		
		Bolt, carriage, 3/8 x 1-1/2" (2 used)		
24	L 483-1	Cylinder head, 1-1/16" bore. Uses K1589 key right .....	375 to ---	11-1/4
25	1160 S	Shaft, 1-1/16" rd., 49-3/4" long. Uses K-587 and K-589 keys .....	375 to ---	12-1/2
		Shaft complete with 1 L-482, 2 L-483, 1 L-484, 1 L-585, 2 L-557A, 2 1161S, 1 1309SA, and 1 1310SA .....	375 to ---	65

UPPER CYLINDER

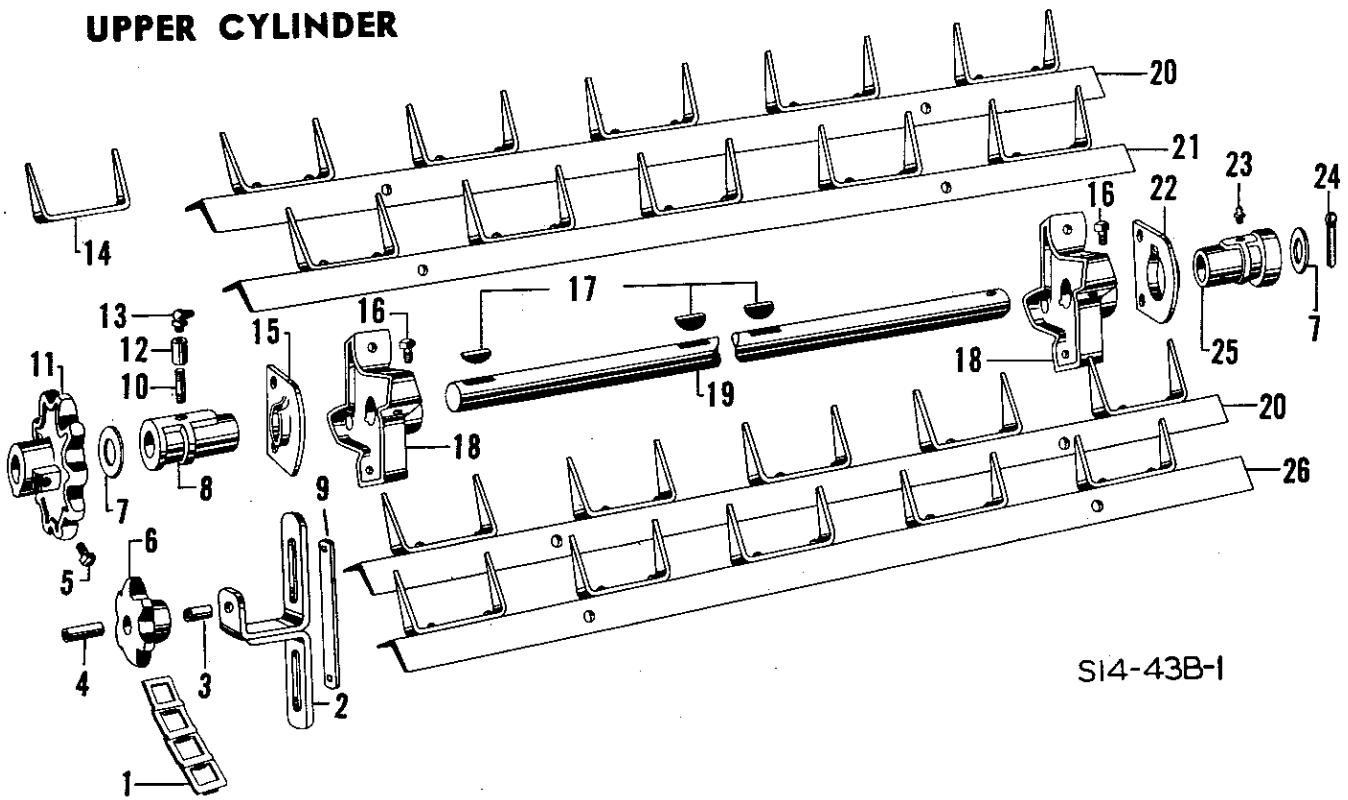

SI4-43B-1

NO. 18 SPREADER

LOT 375 to

Ref.	Part No.	Description	Lot No.	Wt.Lbs.
1	52	Steel chain link (complete chain 41 links) .....	375 to ---	2 oz.
2	1464 SA	Chain tightener bracket .....	375 to ---	3-1/4
	AA 1464 SA1	Chain tightener complete with sprocket, bolt and bushing .....	375 to ---	5-1/4
3	K 2013	Fiber bushing, 23/32" O.D., 19/32" I.D., 1-7/16" long .....	375 to ---	1 oz.
4	K 2030	Spacer, 9/16" O.D., 1-9/16" long .....	375 to ---	1 oz.
5	K 1942	Set screw, 1/2 x 7/8" cup point, low square head .....	375 to ---	1 oz.
6	L 571 A	6-tooth tightener sprocket .....	375 to ---	1
		Bolt, machine, 3/8 x 2-1/2" .....		
	AL 571 A	6-tooth tightener sprocket with bolt and bushing. ....	375 to ---	2
7	K 872	Washer, 1-3/4" O.D., 1-1/32" I.D., 1/16" thick .....	375 to ---	1 oz.
8	L 363	Bearing, left, 1" bore .....	375 to ---	1-1/4
9	1749 S	Reinforcement plate for idler bracket .....	375 to ---	1/4
		Bolt, carriage, 3/8 x 1-1/2" (2 used) .....		
10	K 637	Pipe nipple, 1/8" I.D., 1-1/4" long .....	375 to ---	1 oz.
11	L 525	10-tooth sprocket, 1" bore. Uses K-589 key .....	375 to ---	5
	L 416	8 tooth sprocket 1" bore .....		
12	K 655	Pipe coupling, 1/8" .....	375 to ---	1 oz.
13	K 624	Grease fitting, 1/8" thread, 90-Degree elbow .....	375 to ---	1 oz.
14	1527 S	Cylinder bar tooth .....	375 to ---	1/2
		Rivet, oval head, 5/16 x 3/4" (2 used) .....		
15	A 399 S	Bearing plate, left, 3/16 x 4" flat, 3-29/32" long .....	375 to ---	1
		Bolt, carriage, 3/8 x 7/8" (2 used) .....		
16	K 1184	Set screw, 1/2" dia., 3/4" long (2 used) .....	375 to ---	1 oz.
17	K 589	No. 13 Woodruff key, 3/16" thick, 1" long .....	375 to ---	1 oz.
18	L 489	Cylinder head, 1" bore. Uses K-589 key .....	375 to ---	3-1/2
19	1158 S	Shaft, 1" rd., 49-7/8" long .....	375 to ---	11-1/4
	A 1158 S	Shaft, complete with, 1 L-358, L-363, 2 L-489, 1 L-525, 1 A-398S and 1 A-399S .....	375 to ---	23-1/2
20	1156 SA	Cylinder bar with teeth, 1-1/4 x 1-1/4 x 5/32" angle, 42" long (2 used) .....	375 to ---	7
		Bolt, machine, 3/8 x 1" (2 used) .....		
21	1157 SA	Cylinder bar with teeth, 1-1/4 x 1-1/4 x 5/32" angle, 42" long .....	375 to ---	7
		Bolt, machine, 3/8 x 1" (2 used) .....		
22	A 398 S	Bearing plate, right, 3/16 x 4" flat, 3-29/32" long .....	375 to ---	1
		Bolt, carriage, 3/8 x 7/8" (2 used) .....		
23	K 621	Grease fitting, 1/8" pipe thread, straight .....	375 to ---	1 oz.
24	K 1107	Cotter pin, 5/16" dia., 1-1/4" long .....	375 to ---	2 oz.
25	L 358	Bearing, right, 1" bore .....	375 to ---	1-1/4
26	1155 SA	Cylinder bar with teeth, 1-1/4 x 1-1/4 x 5/32" angle, 42" long .....	375 to ---	7
		Bolt, machine, 3/8 x 1" (2 used) .....		



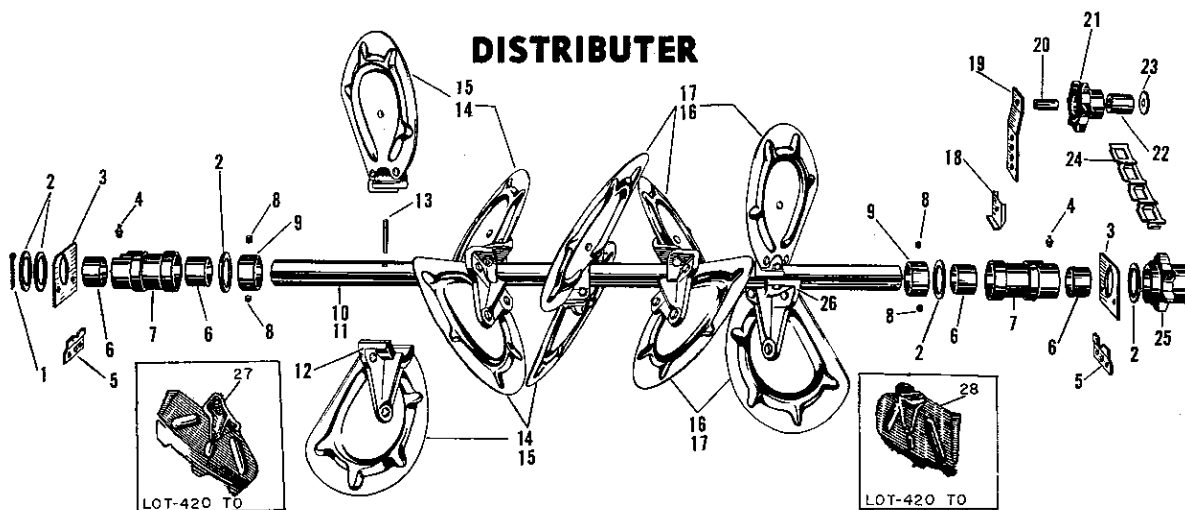

NO. 18 SPREADER

LOT 375 to

Ref.	Part No.	Description	Lot No.	Wt.Lbs.
1	K 1096	Cotter pin, 1/4 x 2".....	375 to ---	2 oz.
2	K 1786	Washer, 2-1/2" O.D., 1-21/32" I.D., 3/32" thick (5 used).....	375 to ---	1 oz.
3	0573 SR	Distributor bearing plate, 3/16 x 4" flat, 4-3/4" long (2 used).....	375 to ---	3/4
4	K 626	Grease fitting, 1/4", 28 thread, straight (2 used).....	375 to ---	1 oz.
5	0574 SR	Keeper for distributor bearing, 1/8 x 1-3/4" flat, 4" long, (2 used), Order 0574-SR1.....	375 only	1/4
	0574 SR1	Keeper for distributor bearing, 1/8 x 1-3/4" flat, 4" long, (2 used).	381 to ---	1/4
6	K 1841	Bushing, fiber, 1-7/8" O.D., 1-5/8" I.D., 1-1/2" long, (4 used).....	375 to ---	1 oz.
7	72 SRA	Distributor bearing assembly, 1-5/8" bore with 2 K-1842 bushing, (2 used).....	375 to ---	2-3/4
8	K 1349	Set screw, 5/16 x 3/8" low square head, cup point (4 used).....	375 to ---	2 oz.
9	73 SR	Distributor shaft bearing collar, 1-5/8" bore (2 used).....	375 to ---	1/2
	155 SRA	Wiper arm assembly (right).....		
	156 SRA	Wiper arm assembly (left).....		
10	A 0621 SR	Distributor complete with paddles, bearings and sprocket.....	375 to 413	68
	201433	Distributor complete with paddles, bearings and sprocket.....	420 to ---	68
11	0621 SR	Distributor shaft, 1-5/8" tubing, 45-3/8" long.....	375 to 413	11
	201179	Distributor shaft, 1-5/8" tubing, 45-3/8" long.....	420 to ---	11
12	71 SR	Distributor paddle casting, left (5 used), Order 200039.....	375 to 413	2-3/4
13	0604 SR	Pin for distributor paddle, 3/8" rd., 2-5/16" long (10 used).....	375 to ---	1 oz.
14	0571 SRA	Distributor paddle assembly with casting, left, (5 used), Order 0571-SRA-1.....	375 only	5
	0571 SRA-1	Distributor paddle assembly with casting, left, (5 used).....	381 to 413	5-1/4
15	0571 SR	Distributor paddle, left, (Order 200049).....	375 only	2-1/4
	0571 SR-1	Distributor paddle, left, (Order 200049).....	381 to 413	2-1/4
	200049	Distributor paddle, left.....		
16	0572 SRA	Distributor paddle assembly with casting, right (5 used), Order 0572-SRA-1.....	375 only	5
	0572 SRA-1	Distributor paddle assembly with casting, right (5 used).....	381 to 413	5-1/4
17	0572 SR	Distributor paddle, right, (Order 200050).....	375 only	2-1/4
	0572 SR-1	Distributor paddle, right.....	381 to 413	2-1/4
	200050	Distributor paddle, right.....		2-1/4
18	1173 S	Lock for chain tightener arm.....	375 to ---	2 oz.
19	1323 S	Chain tightener arm, 5/16 x 1-1/4" flat, 6" long.....	375 to ---	3/4
20	K 2030	Spacer, 9/16" O.D., 5/64" I.D., 1-9/16" long.....	375 to ---	1/4
21	L 571A	6-tooth tightener sprocket with K-2013 bushing for No. 52 chain.....	375 to ---	2
22	K 2013	Bushing, fiber, 23/32" O.D., 19/32" I.D., 1-7/16" long.....	375 to ---	1 oz.
23	K 2880	Washer, electro galvanized, 1" O.D., 7/16" I.D., 1/16" thick.....	375 to ---	1 oz.
24	52	Steel chain, 44 links.....	375 to ---	1 oz.
25	75 SR	7-tooth sprocket in distributor shaft, for No. 52, chain 1-5/8" bore. Rivet, button head, 3/8 x 2-1/2"	375 to ---	2
26	70 SR	Distributor paddle casting, right, (5 used).....	375 to 413	2-3/4
	200038	Distributor paddle casting, right, (5 used).....	420 to ---	2-3/4
27	200039	Distributor paddle casting, left (4 used).....	420 to	
	200685	Distributor paddle assembly with casting, left (4 used).....	420 to	
	200687	Distributor paddle, left (4 used).....	420 to	
28	200038	Distributor paddle casting, right, (4 used).....	420 to	
	200684	Distributor paddle assembly with casting, right (4 used).....	420 to	
	200686	Distributor paddle, right.....	420 to	

# FEED SHAFT AND CONVEYOR

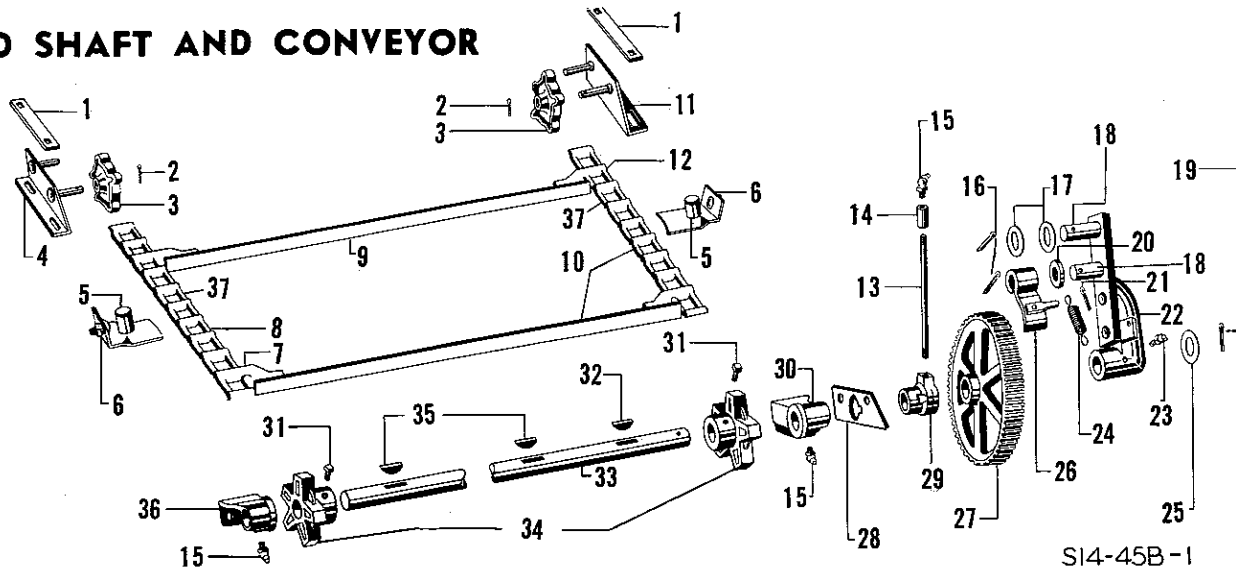

## NO. 18 SPREADER

LOT 375 to

Ref.	Part No.	Description	Lot No.	Wt. Lbs.
1	1412 S	Clamp strap for idler, 3/16 x 1" flat, 8" long Bolt, carriage, 3/8 x 1-1/4" (2 used)	375 to ---	1/2
2	K 1081	Cotter pin, 3/16" dia., 1" long	375 to ---	1 oz.
3	L 473	5-tooth idler sprocket	375 to ---	1-1/2
4	1414 SA	Conveyor tightener with studs, left, 2-1/2 x 1-1/2 x 3/16" angle, 9" long	375 to ---	2-3/4
5	L 307	Conveyor guide Rivet, W.B. head, 5/16 x 1-1/4"	375 to ---	1/4
6	B 381 SA	Conveyor slide, complete, 1/8 x 3" flat, 5-1/8" long Bolt, carriage, 3/8 x 7/8"	375 to ---	1-1/4
7	67 ARS	Steel attachment link, left Rivet, flat head, 5/16 x 5/8	375 to ---	3 oz.
8	67	Plain steel chain link	375 to ---	2 oz.
9	A 845 S	Conveyor bar with links, 1-3/8 x 1 x 5/32" angle, 34-1/4" long, overall	375 to ---	3-1/4
10	1626 SA	Conveyor chain with No. 67 steel chain and A845S bar, 146 No. 67 plain links, 11 No. 67-ARS and 11 No. 67-ALS attachment links; 7 bars each followed by 7 plain links and 4 bars each followed by 6 plain links	375 to ---	72
11	1413 SA	Conveyor tightener with studs, right, 2-1/2 x 1-1/2 x 3/16" angle, 9" long	375 to ---	2-3/4
12	67 ALS	Steel attachment link, right Rivet, flat head, 5/16 x 5/8"	375 to ---	3 oz.
13	K 642	Pipe nipple, 1/8" I.D., 7" long	375 to ---	2 oz.
14	K 655	Pipe coupling, 1/8"	375 to ---	1 oz.
15	K 622	Grease fitting, 1/8" pipe thread, 30-Degree elbow	375 to ---	1 oz.
16	K 1082	Cotter pin, 3/16" dia., 1-1/4" long	375 to ---	1 oz.
17	K 1768	Washer, 1-1/2" O.D., 29/32" I.D., 1/16" thick	375 to ---	1 oz.
18	1556 S	Stud for feed arm tube, 7/8" dia., 2-3/4" long	375 to ---	1/4
19	K 1108	Cotter pin, 5/16" dia., 1-1/4" long	375 to ---	1 oz.
20	1585 S	Feed pawl spacer, 1-1/4" O.D., 7/16" thick	375 to ---	1/4
21	K 1072	Cotter pin, 1/8" dia., 1" long	375 to ---	1 oz.
22	L 481 A	Feed arm, complete, with pawl and spring	375 to ---	7
23	K 623	Grease fitting, 1/8" pipe thread, 67-1/2 Degree elbow	375 to ---	1 oz.
24	1439 S	Extension spring, 5/8" O.D., 2-1/4" long overall 20 coils	375 to ---	2 oz.
25	K 1868	Washer, 1-3/4" O.D., 1-3/32" I.D., 5/64" thick	375 to ---	1 oz.
26	311 SA	Feed pawl, 1/4 x 1-1/4" flat, 5-3/4" long	375 to ---	3/4
27	L 383	Ratchet wheel, 1-1/16" bore, uses K-599 key	375 to ---	12-1/4
28	926 S	Angle feed bearing plate Rivet, oval head, 3/8 x 3/4" (2 used)	375 to ---	3/4
29	L 498	Angle feed bearing, 1-1/8" bore	375 to ---	3/4
30	L 469	Feed bearing, right, 1-1/16" bore Bolt, machine, 3/8 x 1" (2 used)	375 to ---	3/4
31	K 1156	Set screw, 3/8 dia., 5/8" long, low head	375 to ---	1 oz.
32	K 599	No. 14 Woodruff key, 7/32" thick, 1" long	375 to ---	1 oz.
33	878 S	Shaft, 1-1/16" rd., 44-5/8" long. Uses K-589 and K-599 keys	375 to ---	11-1/4
33	878 SA	Shaft, complete with 2 L-347 sprockets	375 to ---	15
34	L 347	5-tooth feed sprocket, 1-1/16" bore. Uses K-589 key (Order 201341)	375 to 413	2
34	201341	5-tooth feed sprocket, 1-1/16" bore	420 to ---	
35	K 589	No. 13 Woodruff key, 3/16" thick, 1" long	375 to ---	1 oz.
36	L 470	Feed bearing, left, 1-1/16" bore Bolt, machine, 3/8 x 1" (2 used)	375 to ---	2
37	200653	Conveyor chain, right and left, No. 67	375 to ---	

## FEED MECHANISM

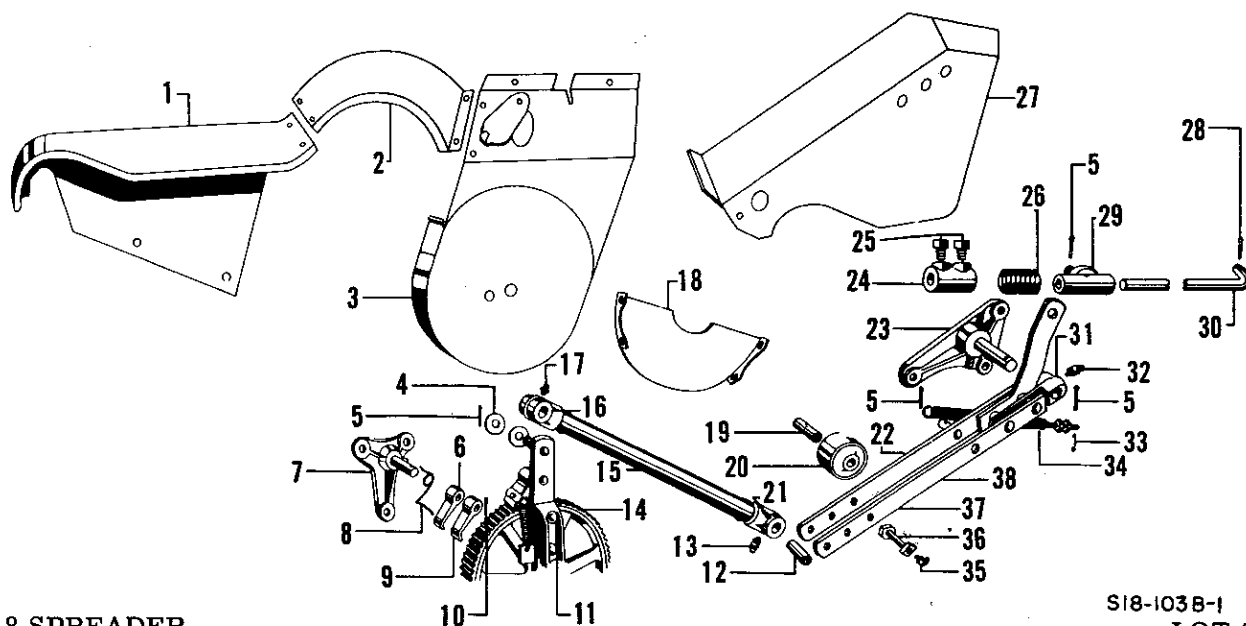

NO. 18 SPREADER

S18-1038-1

LOT 375 to

Ref.	Part No.	Description	Lot No.	Wt. Lbs.
1	0620 SRA	Distributor chain shield .....	375 to ---	3-1/4
		Bolt, machine, 5/16 x 3/4"		
		Bolt, machine, 3/8 x 1"		
		Bolt, machine, 3/8 x 1-1/4"		
2	1318 S	Shield connecting distributor and ratchet wheel shields, 18" long .....	375 to ---	1-1/2
		Machine screw, 1/4 x 1/2" (4 used)		
3	1073 SA	Ratchet wheel shield .....	375 to ---	5-1/2
		Bolt, carriage, 5/16 x 1-1/4" (2 used)		
4	K 1768	Washer, 1-1/2" O.D., 29/32" I.D., 1/16" thick .....	375 to ---	1 oz.
5	K 1082	Cotter pin, 3/16" dia., 1-1/4" long .....	375 to ---	1 oz.
6	L 304	Retention pawl, long .....	375 to ---	1/2
7	L 532 A	Retention pawl support with pin .....	375 to ---	1-1/2
		Bolt, carriage, 3/8 x 1-1/2" (3 used)		
8	1440 S	Torsion spring .....	375 to ---	1 oz.
9	L 302	Retention pawl, short .....	375 to ---	1/2
10	K 1072	Cotter pin, 1/8" dia., 1" long .....	375 to ---	1 oz.
11	L 481 A	Feed arm complete with pawl and spring .....	375 to ---	7
12	965 S	Spacer, 7/8" O.D., 1-15/16" long .....	375 to ---	1/4
13	K 623	Grease fitting, 1/8" pipe thread, 67-1/2 degree elbow .....	375 to ---	1 oz.
14	L 383	Ratchet wheel, 1-1/16" bore, uses K-599 key .....	375 to ---	12-1/4
15	1421 SA	Feed mechanism connecting tube .....	375 to ---	4-3/4
16	L 474	Upper insert for feed arm tube .....	375 to ---	1-1/4
		Rivet, oval head, 1/4 x 1-3/4"		
17	K 621	Grease fitting, 1/8" pipe thread, straight .....	375 to ---	1 oz.
18	1232 S	Inner ratchet wheel shield .....	375 to ---	1
		Bolt, carriage, 1/4 x 1/2" (4 used)		
19	1331 S	Bushing for feed roller, 1" O.D., 1-15/16" long .....	375 to ---	1/4
20	L 515	Roller for feed arm .....	375 to ---	1-3/4
21	L 480	Lower insert for feed arm tube .....	375 to ---	1-1/4
		Rivet, oval head, 1/4 x 1-3/4"		
22	A 1328 S	Feed hanger arm with stud, 1/4 x 1-3/4" flat, 16-1/2" long .....	375 to ---	2-3/4
23	L 478 A	Auxiliary feed arm post with pin .....	375 to ---	3
		Bolt, carriage, 3/8 x 1-3/4"		
		Bolt, carriage, 3/8 x 2" (2 used)		
24	L 314	Double set collar .....	375 to ---	1/2
25	K 1155	Set screw, 3/8" dia., 5/8" long .....	375 to ---	1 oz.
26	1435 S	Compression spring, 1-5/16" O.D., 2-3/4" long, 5 coils .....	375 to ---	1/4
27	1348 SA	Auxiliary feed arm shield .....	375 to ---	4
		Bolt, machine, 5/16 x 3/4"		
28	K 1081	Cotter pin, 3/16" dia., 1" long .....	375 to ---	1 oz.
29	L 316	Slide collar .....	375 to ---	1/2
30	1393 S	Feed rod, 9/16" rd., 75-3/4" long .....	375 to ---	5-1/2
31	L 472	Auxiliary feed arm bearing .....	375 to ---	2
		Rivet, W.B. head, 3/8 x 3" (2 used)		
32	K 615	Grease fitting, 1/8" pipe thread, 45 degree elbow .....	375 to ---	1 oz.
33	K 1067	Cotter pin, 3/32" dia., 3/4" long .....	375 to ---	1 oz.
34	1512 S	Extension spring with bolt, 7/8" O.D., 5-1/2" long overall, 37 coils .....	375 to ---	1/4
35	K 624	Grease fitting, 1/8" pipe thread, 90 degree elbow .....	375 to ---	1 oz.
36	1330 S	Feed roller bolt, 5/8" dia., 2-7/8" long .....	375 to ---	1/4
37	L 472 A	Auxiliary feed arm, complete with arms, roller and spring .....	375 to ---	9-3/4
38	1328 S	Feed hanger arm, 1/4 x 3/4" flat, 16-1/2" long .....	375 to ---	2-3/4

## MAIN DRIVE

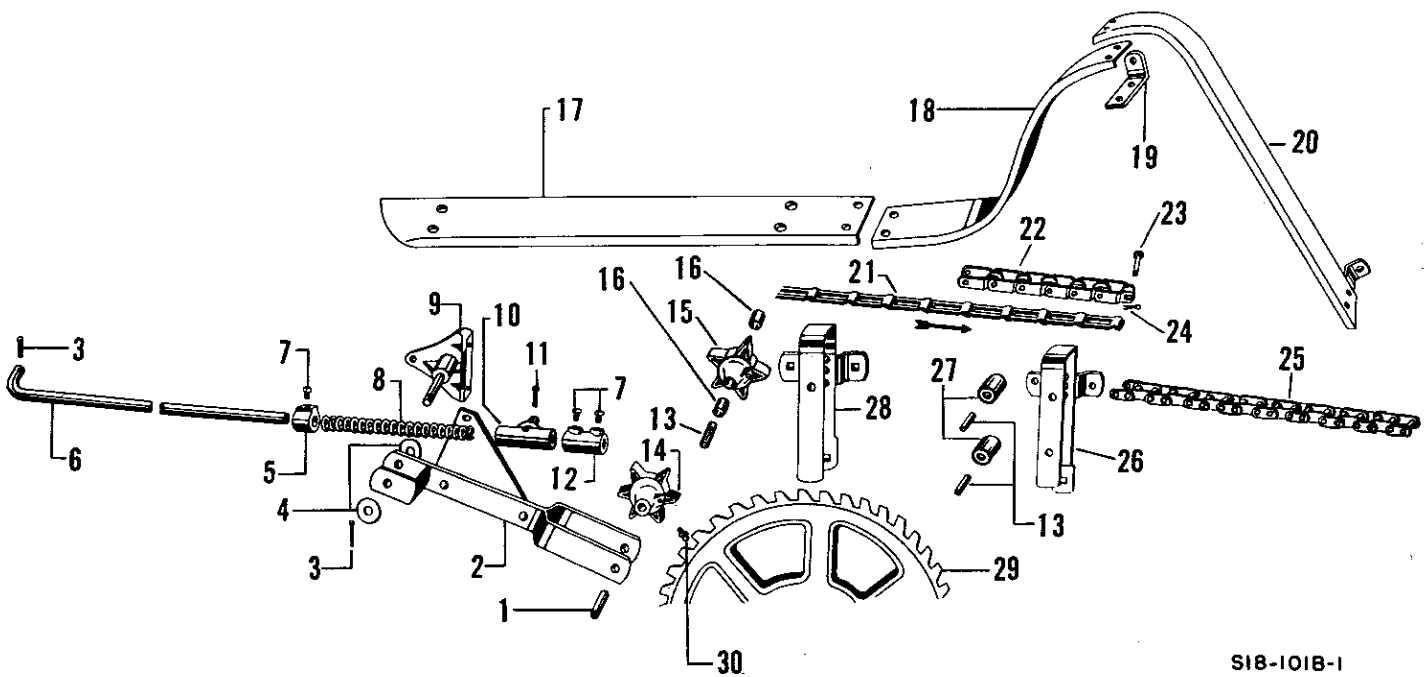

S18-1018-1

## NO. 18 SPREADER

LOT 375 to

Ref.	Part No.	Description	Lot No.	Wt.Lbs.
1	378 S	Bushing, 19/32" O.D., 2-5/16" long .....	375 to ---	1 oz.
2	1467 SA 1	Drive arm, complete with sprocket .....	375 to ---	5-1/2
3	K 1081	Cotter pin, 3/16" dia., 1" long (2 used).....	375 to ---	1 oz.
4	K 847	Washer, 1-1/2" O.D., 21/32" I.D., 3/32" thick .....	375 to ---	1 oz.
5	L 300	Single set collar.....	375 to ---	1/4
6	0611 SR	Drive rod, 9/16" rd., 58-1/8" long .....	375 to ---	3-3/4
7	K 1155	Set screw, 3/8" dia. 5/8" long (3 used) .....	375 to ---	1 oz.
8	1507 S	Compression spring, 7/8" O.D., 7" long, 23 coils .....	375 to ---	1/4
9	L 523 A	Drive arm post with pin..... Bolt, machine, 3/8 x 1-1/4" (2 used) Bolt, carriage, 3/8 x 1-1/2"	375 to ---	2-3/8
10	L 316	Slide collar .....	375 to ---	1/2
11	K 1082	Cotter pin, 3/16" dia., 1-1/4" long .....	375 to ---	1 oz.
12	L 314	Double set collar.....	375 to ---	1/2
13	1504 S	Bushing, 19/32" O.D., 2-7/16" long (3 used).....	375 to ---	1 oz.
14	L 342	6 tooth idler sprocket..... Bolt, machine, 3/8 x 3-3/4"	375 to ---	1-3/4
15	L 574 A	5 tooth idler sprocket with 2 fiber bushing .....	375 to ---	1-1/2
16	K 2870	Bushing fiber, 7/8" O.D., 5/8" I.D., 1" long (2 used).....	375 to ---	1 oz.
17	0612 SRA	Drive chain shield, 4 x 27" long, 3/64" thick .....	375 to ---	3
18	1045 S	Shield connecting drive chain and upper cylinder chain shields, 4 x 20-1/4" long, 3/64" thick .....	375 to ---	1-1/4
19	1047 S	Top bracket for upper cylinder chain shield, 3/16 x 1" flat, 4-7/8" long .....	375 to ---	1/4
20	1046 SA	Upper cylinder chain shield, 4 x 30" long, 3/64" thick..... Bolt, machine, 1/4 x 3/4" (2 used) Bolt, carriage, 3/8 x 3/4"	375 to ---	1-3/4
21	72	Steel chain link, (complete chain, 57 links).....	375 to ---	2 oz.
22	0853 SRA	Main drive chain complete, 57 links, No. 672 steel pintle.....	381 to ---	13-1/2
23	3097 A	Detachable link, #672 steel pintle chain with pins and cotter pin.....	381 to ---	1/4
24	K 3096 A	Pin, 5/16" dia. x 1-7/8" long, Order K 3096 A-1.....	381 to 418	2 oz.
25	K 3096 A-1	Pin, 5/16" dia. x 1-7/8" long .....	420 to ---	
26	K 1066	Cotter pin, 3/32" dia. x 1/2" long .....	375 to ---	1 oz.

## MAIN DRIVE (CON'T)

Ref.	Part No.	Description	Lot No.	Wt.Lbs.
25	1757 SA	Tubular drive chain, Order 0853 SRA .....	375 only	
	K 2266 A	Offset link assembly .....	375 only	1 oz.
	K 2267 A	Pin link assembly.....	375 only	1 oz.
	K 2268 A	Roller link assembly.....	375 only	1 oz.
	0853 SRA	Drive chain.....	375 only	1 oz.
26	977 SA 1	Rear chain straddler with bracket, Order 977 SA 2 .....	375 to 381	3
	977 SA 2	Rear chain straddler with bracket .....	385 to ---	
		Bolt, carriage, 3/8 x 1-1/2" (3 used)		
27	L 418	Straddler roller (2 used).....	375 to ---	1
28	1418 SA 1	Chain straddler with bracket .....	375 to ---	3
		Bolt, carriage, 3/8 x 1-1/2" (3 used)		
29	L 519	32 tooth main drive sprocket, Order 122 SR.....	375 to 395	23-1/2
	122 SR	32 tooth main drive sprocket .....	413 to ---	23-1/2
		Bolt, machine, 1/2 x 1-3/4 (3 used)		
30	K 610	Grease fitting, 5/16" drive type.....	375 to ---	1 oz.

## SPECIAL LEVER FORD AND FERGUSON TRACTORS

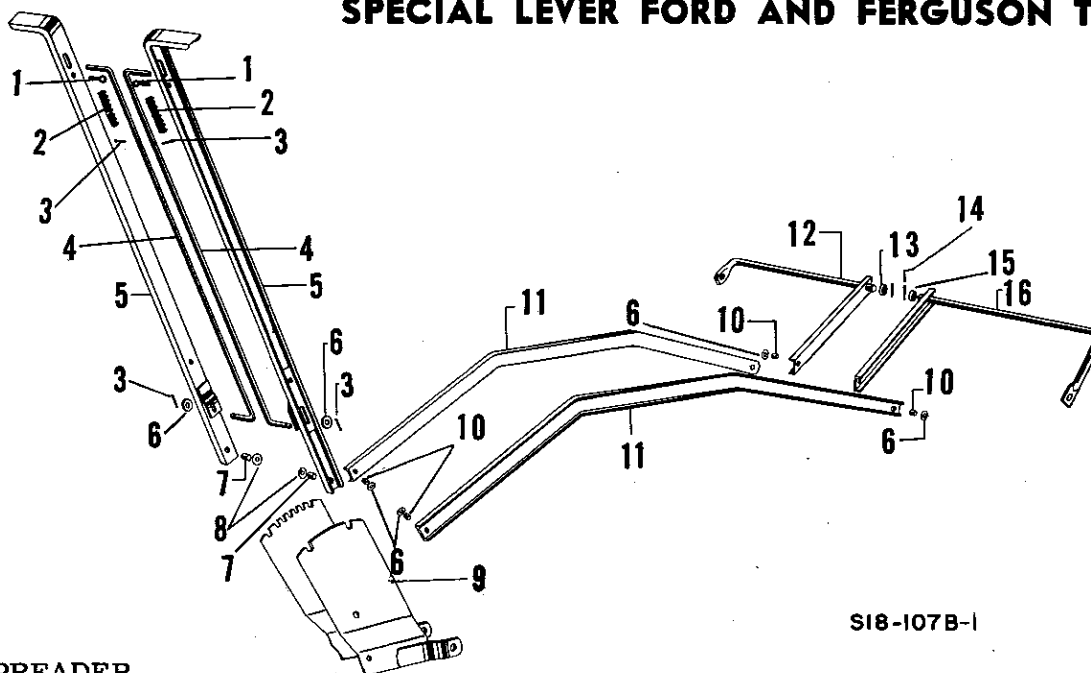

S18-107B-1

### NO. 18 SPREADER

LOT 375 to

Ref.	Part No.	Description	Lot No.	Wt.Lbs.
1	023 HS	Cotter pin, 5/16" dia., 3/4" long (2 used) .....	375 to ---	1 oz.
2	1285 S	Compression spring, 11/16" O.D., 3-5/8" long 14-1/2" coils..... (2 used) .....	375 to ---	1 oz.
3	K 1071	Cotter pin, 1/8" dia., 3/4" long (2 used) .....	375 to ---	1 oz.
4	1271 S	Lever latch, 3/8" rd., 35-1/2" long (2 used) .....	375 to ---	1
5	1207 SA	Main lever with clips, 1-1/2 x 3/16" channel, 45" long .....	375 to ---	5
		Bolt, machine, 1/2 x 1-1/4"		
	0654 SRA	Main lever, complete with latch and spring .....	375 to ---	7
		Bolt, machine, 1/2 x 1-1/4"		
6	K 2880	Washer, 1" O.D., 7/16" I.D., 1/16" thick (6 used) .....	375 to ---	1 oz.
7	1283 S	Bushing, 11/16" O.D., 3/16" long .....	375 to ---	1 oz.
8	K 2881	Washer, 1-3/8" O.D., 9/16" I.D., 1/16" thick (2 used) .....	375 to ---	1 oz.
9	1274 SA	Sector assembly, complete .....	375 to ---	13
		Bolt, machine, 1/2 x 4-1/2" (2 used)		
10	K1651	Bushing, 9/16" O.D., 7/32" long (4 used) .....	375 to ---	1 oz.
11	0659 SR	Push rod, 1-15/32 x 15/32 x 5/32" channel, 50" long (2 used) .....	375 to ---	5-1/2
		Bolt, machine, 3/8 x 1-1/4" (2 used)		
12	0653 SRA	Drive rod control shaft with lever base .....	375 to ---	7
13	1463 S	Spacer, 1" I.D., 1/4" long .....	375 to ---	1 oz.
14	K 1083	Spring cotter, 3/16" dia., 1-1/2" long (2 used) .....	375 to ---	1 oz.
15	0648 SR	Spacer, 1" standard black pipe, 5/8" long .....	375 to ---	1 oz.
16	0652 SRA	Feed rod control shaft with lever base .....	375 to ---	6